

Hamptons

INTERNATIONAL



Delawyk Crescent, London, SE24

3  1  1 

£690,000

(£685,000)

Property details



Key features

- **3 Bedrooms**
- **1 Reception Room**
- **Kitchen**
- **1 Bathroom**
- **Garden**

Delawyk Crescent, London, SE24

3 1 1

£690,000
(£685,000)

Description

A three bedroom 1960s house in a great location within easy reach of Herne Hill & North Dulwich. A wonderful opportunity to own a bright, practical 1960s home in a highly desirable location. With potential to modernise, the house has three bedrooms and measures 955 square feet. There is a garden to the rear and the house is set towards the rear of the estate, moments from the chickens. The freehold acquisition process has been initiated for the buyer to take over. The property is being sold chain free. Call us for more information. Situation Delawyk Crescent is located just off Half Moon Lane directly between the amenities of Herne Hill and Dulwich Village. North Dulwich station (London Bridge) is just 0.3 miles away and Herne Hill station (London Victoria, Blackfriars) is just 0.5 miles away. It is also ideally situated for all the local schools, both state-funded and independent with the Charter secondary school (0.4 miles away) and Judith Kerr primary school (500 feet away).

















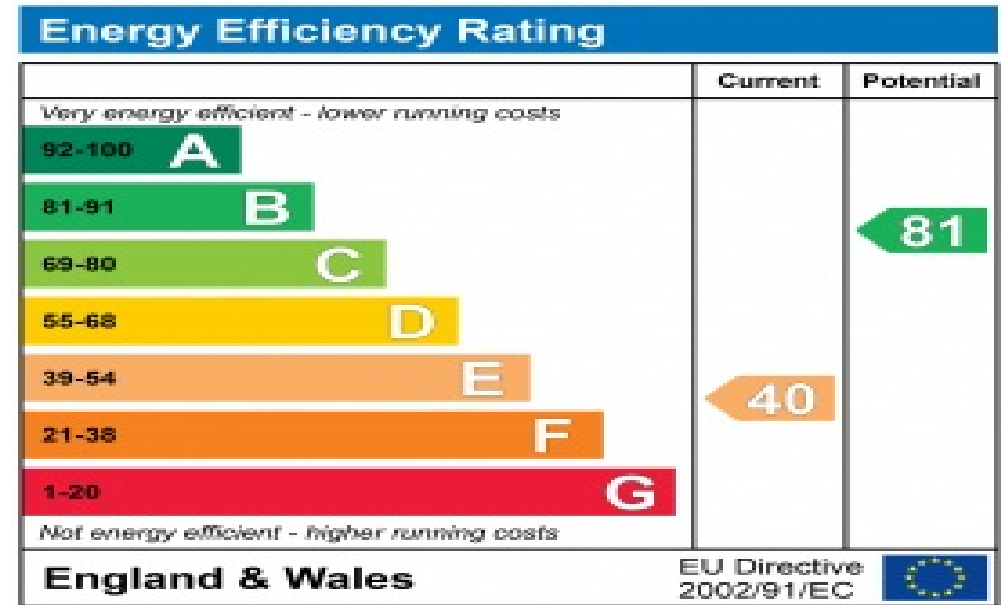

Floor plan

DELAVAL CRESCENT

Approximate Gross Internal Area
Ground floor = 496 sq. ft. (46.1 sq. m.)
First floor = 440 sq. ft. (40.9 sq. m.)
Total = 936 sq. ft. (87.0 sq. m.)

OH 2102.4 = Ceiling Height



First Floor

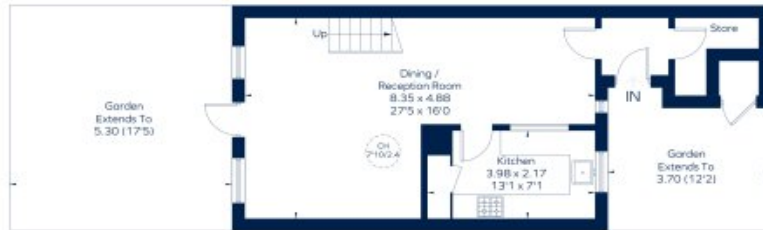

Ground Floor

This plan is for layout guidance only. Not drawn to scale unless stated. Windows and door openings are approximate. All the every care is taken in the preparation of this plan, please check all dimensions, areas and volumes before making any decisions about your home.

Location



Hamptons

INTERNATIONAL

+44 (0)20 8618 4551

international@hamptons.co.uk

www.hamptons-international.com