

# Hamptons

INTERNATIONAL



**Millharbour, LONDON, E14**

3  2  1 

OFFERS IN EXCESS OF

**£1,500,000**

**(£1,500,000)**

## Property details



### Key features

- **3 Double Bedrooms**
- **2 Luxury Bathrooms**
- **2 Allocated Parking Spaces**
- **Circa 1900sq.ft Internal Area**
- **1400sq.ft Private Terrace**
- **South Facing**
- **Chain Free**
- **Very High Specification**
- **2 Additional Balconies**
- **24hr Concierge**

### Attributes

- **Apartment**

## Millharbour, LONDON, E14

3 🏠 2 🚗 1 📄

OFFERS IN EXCESS OF  
**£1,500,000**  
**(£1,500,000)**

---

## Description

This extremely luxurious 3 bedroom apartment in the prestigious Ability Place development has been tastefully upgraded by the current owners. This apartment offers an exceptional living experience with breath-taking water views and 270° degree views from the immaculate private terrace. The property is designed to the highest standards, combining contemporary style with practical living spaces. The spacious apartment measures close to 1900sq.ft. The open-plan living and dining area is perfect for relaxing or entertaining, featuring floor-to-ceiling windows and an abundance of natural light throughout. The impressive south facing private terrace extends directly off the living room and offers panoramic 270° views towards Canary Wharf and Milwall Dock. The modern kitchen has been tastefully updated in the last year, and is fully equipped with top-of-the-line integrated appliances, sleek cabinetry, an overspill quartz worktop and a very trendy coffee and drinks bar. This kitchen is ideal for culinary enthusiasts. The master bedroom is a serene retreat with its own 'spa like' en-suite bathroom, walk in wardrobe with bespoke cabinetry and direct access to a separate private balcony overlooking the docks. The en-suite bathroom has been designed to the highest of standards, with a large freestanding bathtub, a large enclosed shower, modern gold hardware and ample storage. The second bedroom, also sizeable and has an additional private balcony overlooking the waterway. The third bedroom is a large double bedroom and can easily be used as a bedroom or home office. The second and third bedrooms are serviced by another stylish bathroom with a large walk in shower, again designed to the highest standard and in keeping with the en-suite bathroom. Each room is designed with comfort and elegance in mind, providing ample storage and living space. This rarely available apartment is unlike any other and must be viewed, offered to the market chain free. Outside The highlight of this property is the expansive private terrace measuring close to 1400sq.ft, offering panoramic views of the water and a perfect setting for outdoor dining, relaxation, or hosting gatherings. This outdoor space significantly enhances the overall living experience, providing a tranquil escape from the urban environment. Situation Situated in the heart of South-Quay, Ability Place is well-connected with excellent transport links, including South Quay DLR and Canary Wharf Underground station, providing easy access to the City and the rest of London via the Elizabeth and Jubilee Lines. The area boasts a variety of local amenities, including shops, restaurants, and recreational facilities, making it an ideal location for families and professionals alike. Residents of Ability Place benefit from a range of premium amenities, including a 24/7 concierge service and state-of-the-art gym. The property also comes with 2 allocated underground parking spaces for added convenience. Property Ref Number: HAM-19850









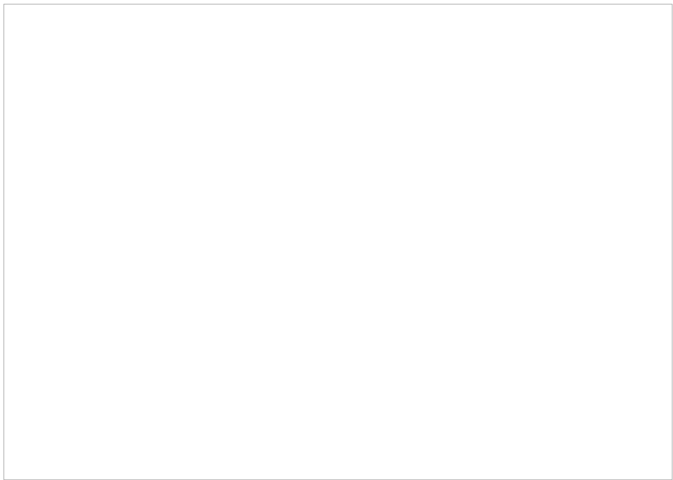



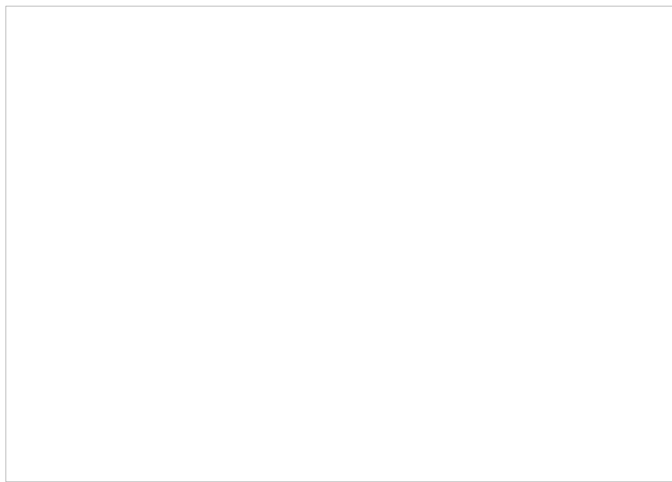



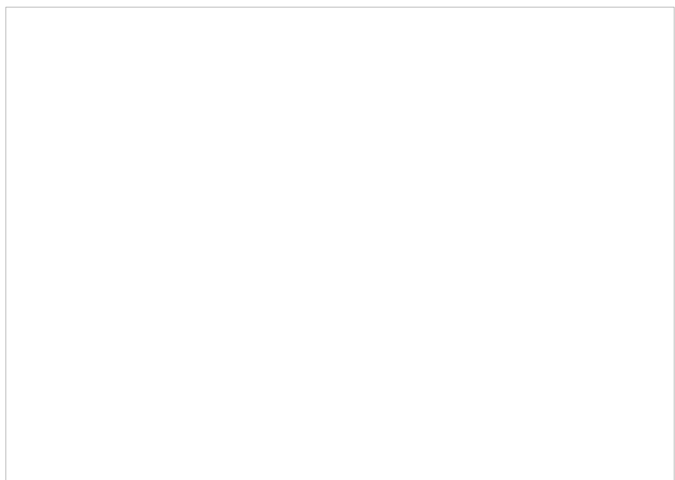



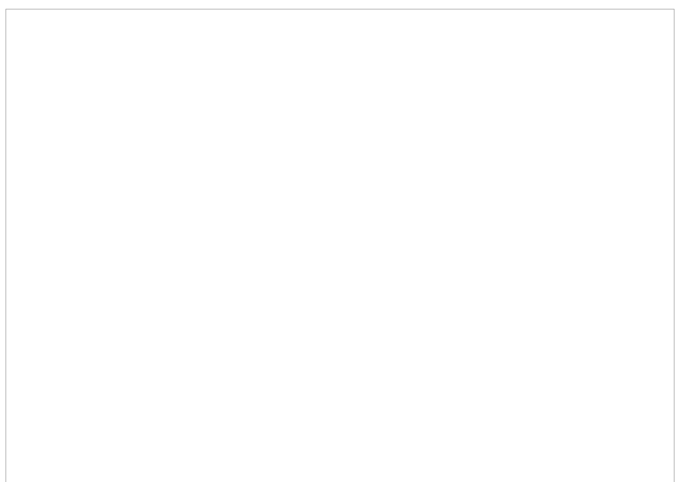



# Floor plan

---

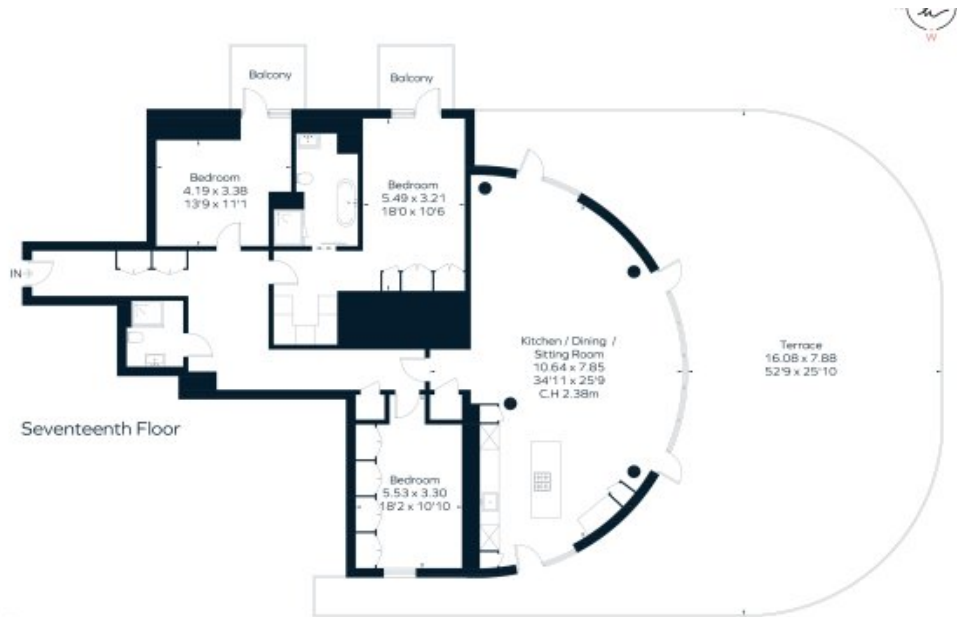

# Location

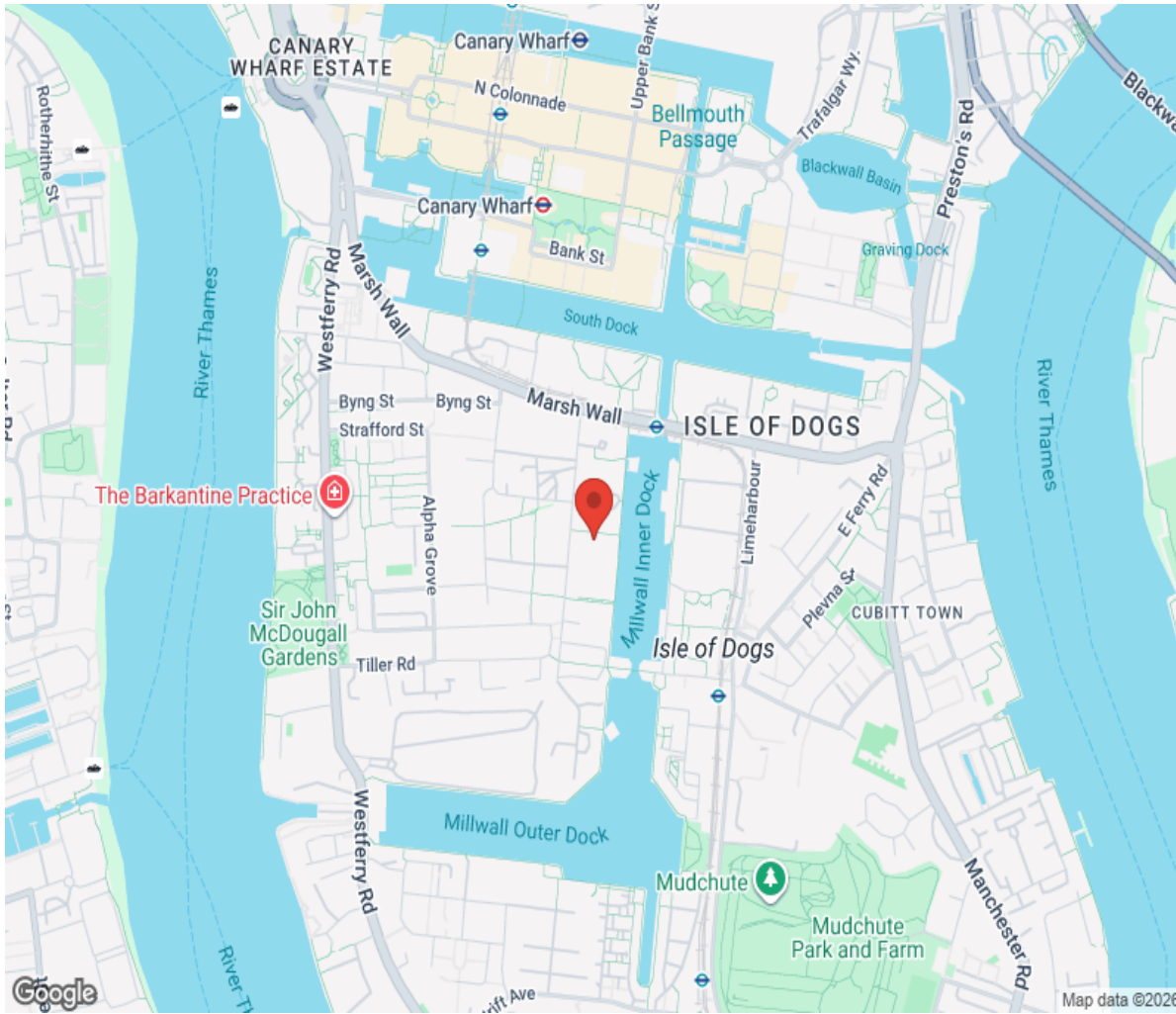

# Hamptons

INTERNATIONAL

**+44 (0)20 8618 4551**

**[international@hamptons.co.uk](mailto:international@hamptons.co.uk)**

**[www.hamptons-international.com](http://www.hamptons-international.com)**