

Hamptons

INTERNATIONAL



Kensington Road London W8

4  4  2 

£20,000

(£15,000)

Property details



Attributes

- Apartment

Kensington Road London W8

4 🏠 4 🚗 2 📺

£20,000
(£15,000)

Description

A magnificent and elegantly designed four bedroom, four bathroom apartment situated on High Street Kensington, one of London's most prestigious locations. The apartment starts with a large hallway and leads into the beautifully decorated reception room, adjacent to the separated dining area, perfect for both entertaining and everyday living. This beautifully furnished residence boasts generous proportions and abundant natural light, spanning approximately 2,590 sq ft. All four bedrooms in this property are accompanied by an ensuite, with the spacious principal bedroom set at the back of the apartment. The modern kitchen is fully fitted with high-end appliances, while wooden flooring runs throughout the home. Overlooking Kensington Gardens, this apartment is within a well maintained building benefiting from a porter, and is available furnished. To check broadband and mobile phone coverage please visit Ofcom here ofcom.org.uk/phones-telecoms-and-internet/advice-for-consumers/advice/ofcom-checker Situation Located in a stunning stucco-fronted building on Kensington High Street, the flat enjoys breathtaking views over Hyde Park and is within walking distance of boutiques, fine dining, and cultural landmarks. With Kensington High Street station (Circle and District lines) moments away and Knightsbridge nearby, this home is perfectly positioned for convenient city living. Four bedrooms Four bathrooms Ground floor Wooden flooring Separated dining area Porter Furnished













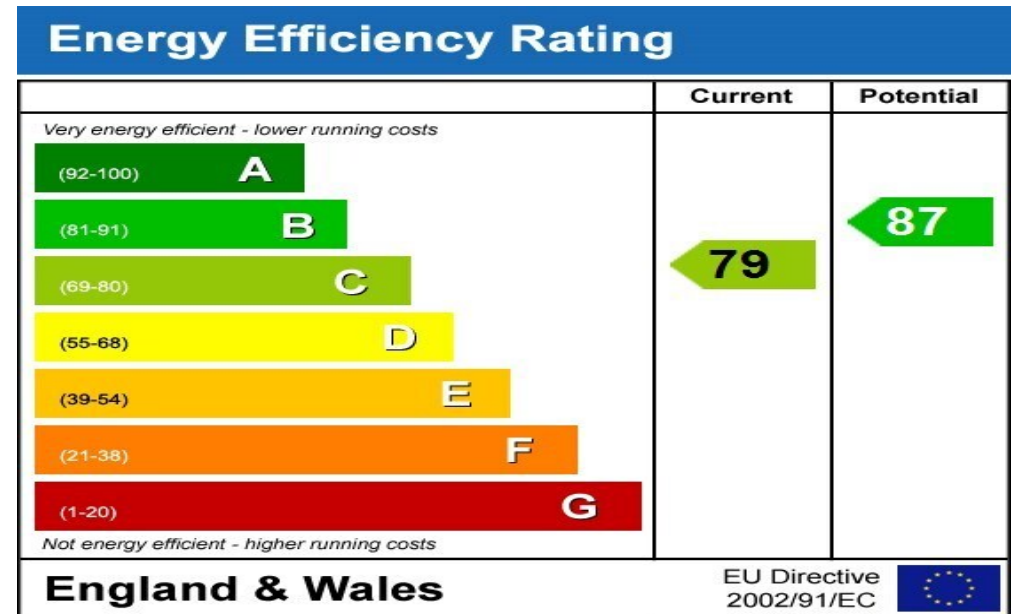

Floor plan

WEAVERTON HIGH STREET

Approximate Gross Internal Area
Ground Floor = 2592 sq. ft. (240.8 sq. m.)

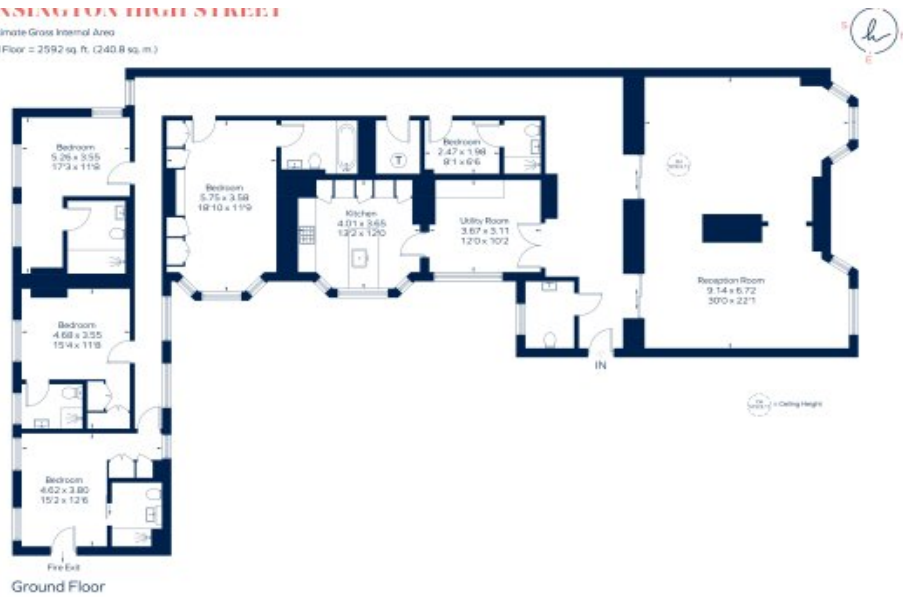

This plan is for layout guidance only. Not drawn to scale unless stated. Windows and door openings are approximate. Whilst every care is taken in the preparation of this plan, dimensions shown are not guaranteed and should be verified by a professional surveyor before making any decisions relating to the property.

Location

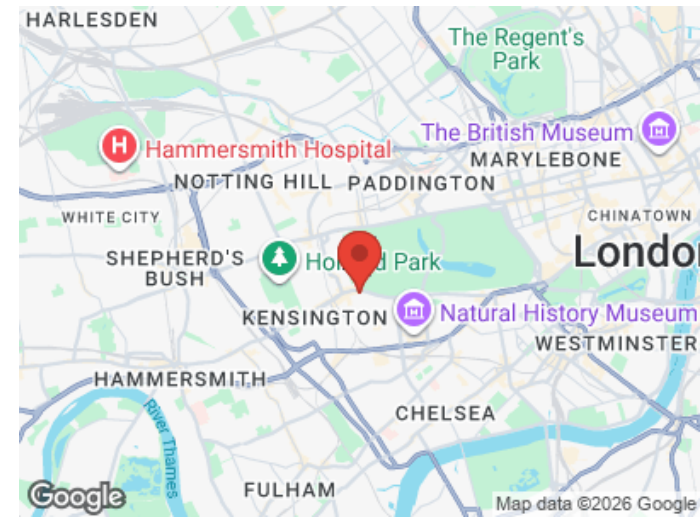
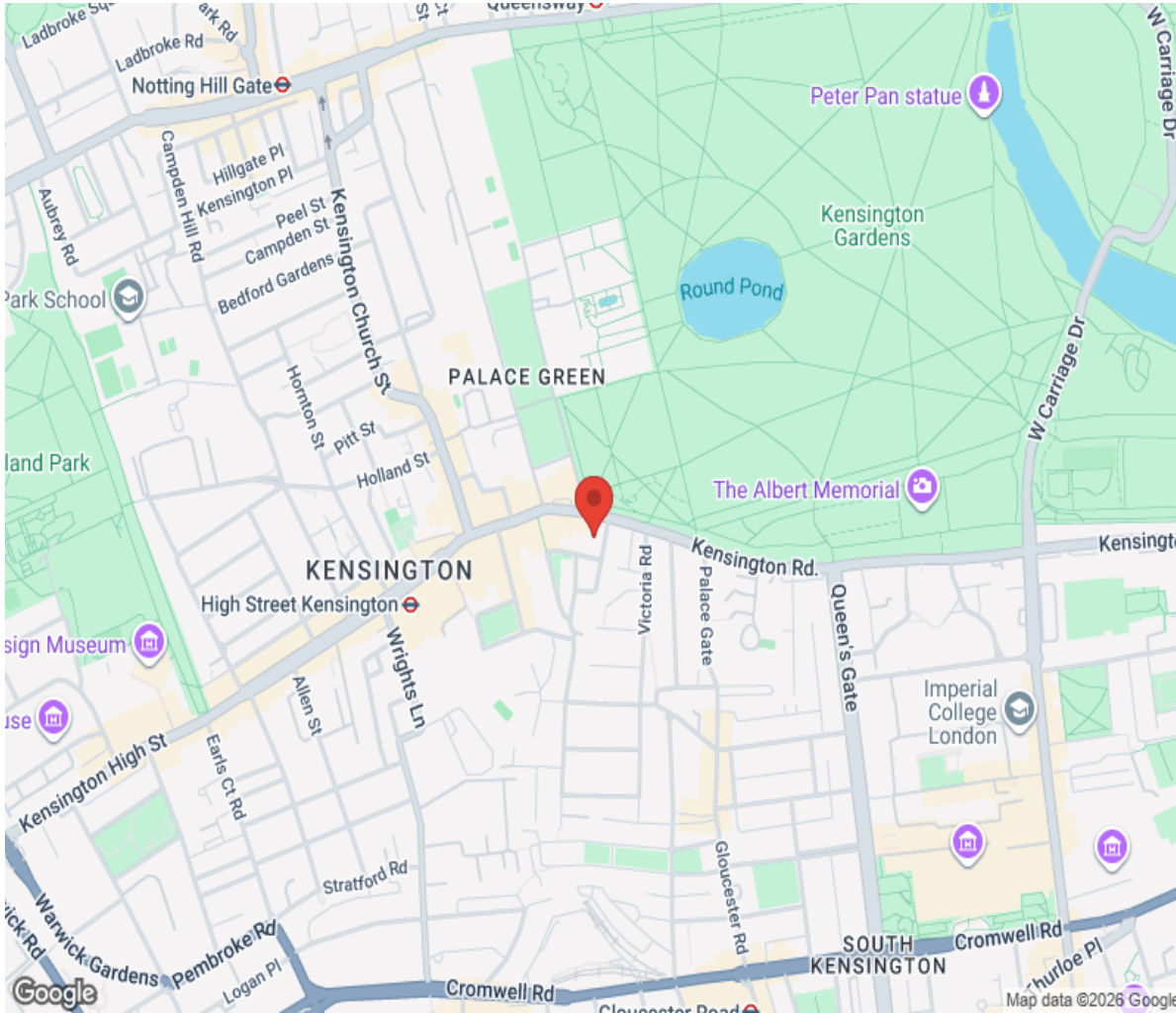

Hamptons

INTERNATIONAL

+44 (0)20 8618 4551

international@hamptons.co.uk

www.hamptons-international.com