



Hamptons

INTERNATIONAL



Swan Street, London, SE1

3  1  1 

£750,000

(£750,000)

Property details



Key features

- Three Bedroom
- Gated Development
- Chain Free
- 908 SQFT
- Two Bathroom
- Borough Tube Station

Attributes

- Apartment

Swan Street, London, SE1

£750,000
(£750,000)

3 🏠 1 🚗 1 📄

Description

Beautifully Presented Three-Bedroom Apartment in a Prestigious Gated Development Moments from Borough Station Set within a highly regarded gated development just moments from Borough Station, this beautifully presented three-bedroom, two-bathroom apartment offers 908 sq. ft. of luxurious and flexible living space. Located on the ground floor, the property opens into a generous hallway with built-in storage, leading to all rooms separately. The impressive 23 ft. reception room provides clearly defined living and dining areas, bathed in natural light and offering the perfect setting for relaxing or entertaining. The stylish, well-appointed kitchen sits neatly in one corner, complementing the open-plan design. All three bedrooms are excellent doubles. The principal bedroom includes a dressing area with built-in wardrobes and a large en-suite shower room. Bedrooms two and three, measuring 16 ft. and 11 ft. respectively, provide superb flexibility — ideal for guests, sharers, or a spacious home office. A modern family bathroom completes the accommodation. Further benefits include a share of freehold, secure entry, and access to attractive communal gardens. Situation Lapwing Court is an impressive and well-maintained development located on Swan Street, one of SE1's most desirable addresses. Residents enjoy immediate access to the vibrant mix of restaurants, cafés, and galleries that define the area, as well as the renowned Borough Market and Bankside district. Transport connections are outstanding, with Borough, London Bridge, Elephant & Castle, and Southwark stations all within easy walking distance, offering access to the Northern, Jubilee, Bakerloo, and National Rail services. Apartments of this size, quality, and location are rarely available and early viewing is highly recommended Property Ref Number: HAM-61870

































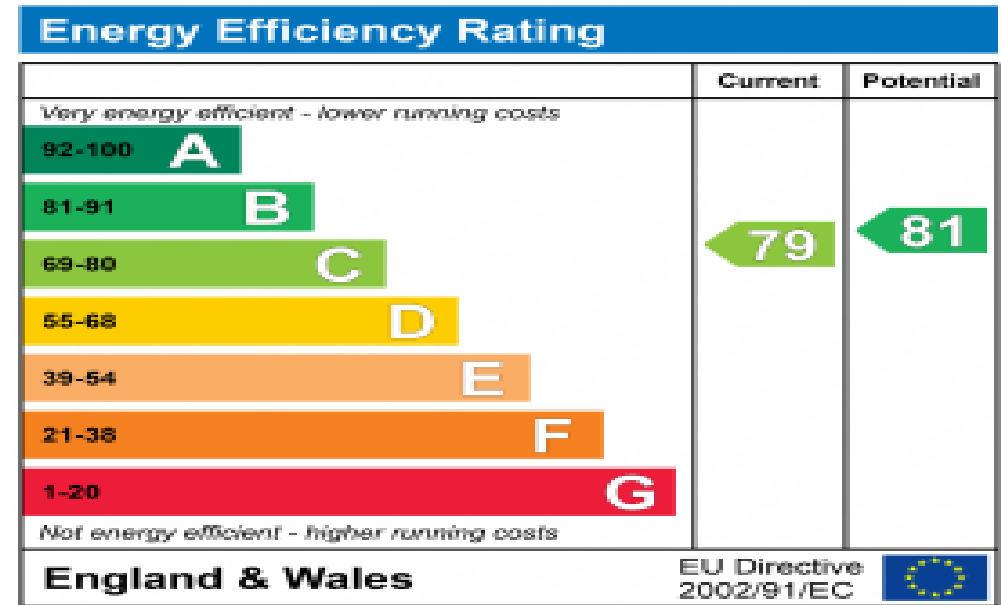

Floor plan

PROPERTY SUMMARY

Approximate Gross Internal Area

938 sq. ft. (84.4 sq. m.)

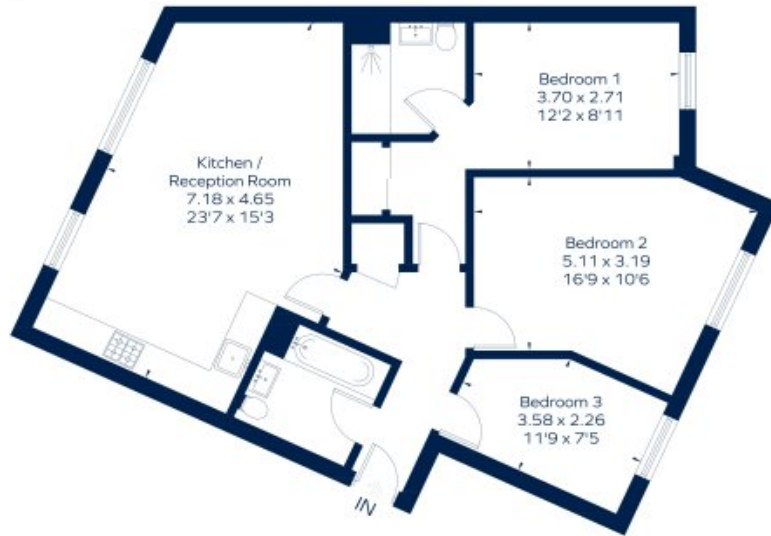

Drawn for information and is not for construction purposes only.

Location

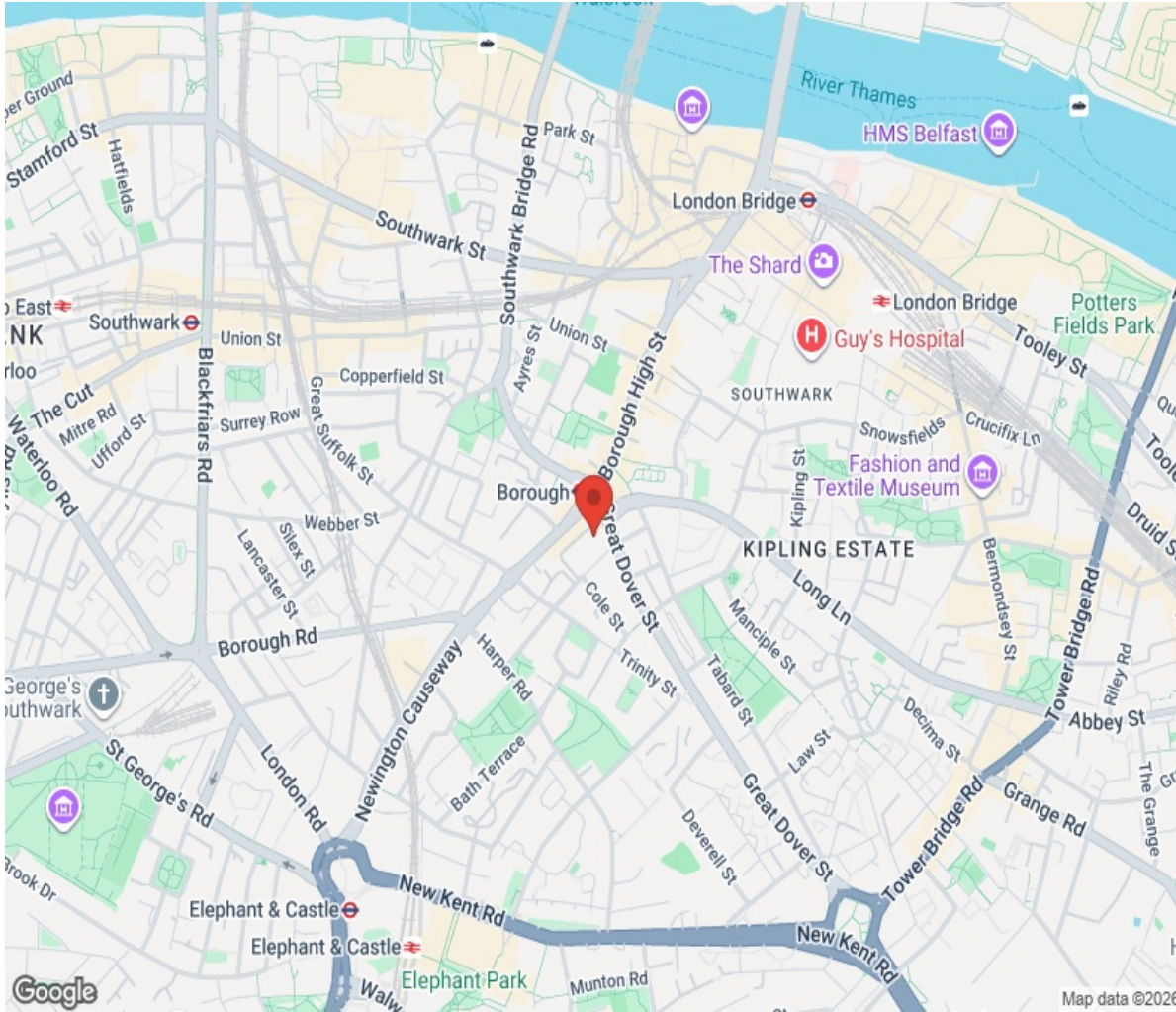

Hamptons

INTERNATIONAL

+44 (0)20 8618 4551

international@hamptons.co.uk

www.hamptons-international.com