

Hamptons

INTERNATIONAL



Greenlands Lane, Great Missenden, HP16

5  3  4 

GUIDE PRICE

£1,100,000

(£1,095,000)

Property details



Key features

- **NO ONWARD CHAIN**
- **Approached via a picturesque lane**
- **Tucked away position**
- **Hugely versatile accommodation over 10,000 sq. ft**
- **Five to six bedrooms & three bathrooms**
- **Three to four reception rooms**
- **Potential for an annexe STPP**
- **Ample parking space & garage**
- **Just a 0.5 mile level walk to the village**

Greenlands Lane, Great Missenden, HP16

GUIDE PRICE

£1,100,000

(£1,095,000)

5 🏠 3 🚗 4 📄

Description

NO ONWARD CHAIN. An extended five/six bedroom detached home in approximately 1/4 acre plot with 3,221 sq. ft. of versatile accommodation, potential for an annexe, tucked away in this highly regarded country lane and sought-after village, just a 0.5 mile level walk to the village amenities. An extended five/six bedroom detached house in approximately 1/4 acre plot with 3,221 sq. ft. of versatile accommodation, with potential for an annexe. The spacious entrance hall provides access to the principal reception rooms. The open plan kitchen/dining/family room, with bi-folding doors from the family room to the terrace leading the eye to the gardens beyond, has been beautifully finished with a generous amount of Shaker style units. Space is provided for a range style cooker with an extractor above, an American style fridge/freezer, and a dishwasher. Accessed via the kitchen and the garage, there is a private courtyard which has a paved seating area. The inner hall also provides access to a useful kitchenette and versatile rooms. The sitting/bedroom is dual aspect with a door opening to the decked seating area to the rear. The other room overlooks the kitchen courtyard and also has a built-in double wardrobe. The shower room is accessed via the kitchenette room. The 30x13ft sitting room overlooks the front aspect, with a brick inglenook fireplace with a wood burning stove and bespoke cabinetry. To the front there is an additional bedroom with built-in storage cupboard. A further shower room is accessed via the entrance hall, which also houses space for a washing machine and tumble drier, and there is a study which overlooks the kitchen courtyard and has a storage cupboard. To the first floor, the landing has a Velux window to the front and built-in eaves storage linen cupboards. The main bedroom is dual aspect with views of the front and rear gardens and benefits from a range of eaves storage cupboards and built-in wardrobes. Two further bedrooms each have a built-in wardrobe and are served by the family bathroom. Outside The property is approached via a gravel driveway which provides off street parking for several vehicles in addition to the garage, with the frontage enclosed by mature hedging. The rear garden is largely laid to lawn with a good sized paved terrace open from the family room and a covered decked seating area providing options for outside entertaining. Within the garden there are mature trees, a greenhouse, a storage shed, a timber summerhouse and is enclosed by timber fencing and mature hedging. The grounds measure approximately 0.24 acres in total. Situation This property is well placed to take advantage of the surrounding and extensive network of public footpaths; dog-walks straight from the front door! The village centre, catering for everyday requirements, is half a mile away as is The Gym & Fitness Centre. Great Missenden (2 miles) has a picturesque high street and offers specialist shops, restaurants, a 20-court tennis club (including padel) and a train service to London Marylebone in approximately 45 minutes (fast train). Central London and Heathrow are 39 and 27 miles away respectively. Buckinghamshire is renowned for its state and private education, including the excellent grammar schools (details of which may be obtained from the local authority). Property Ref Number: HAM-62425

















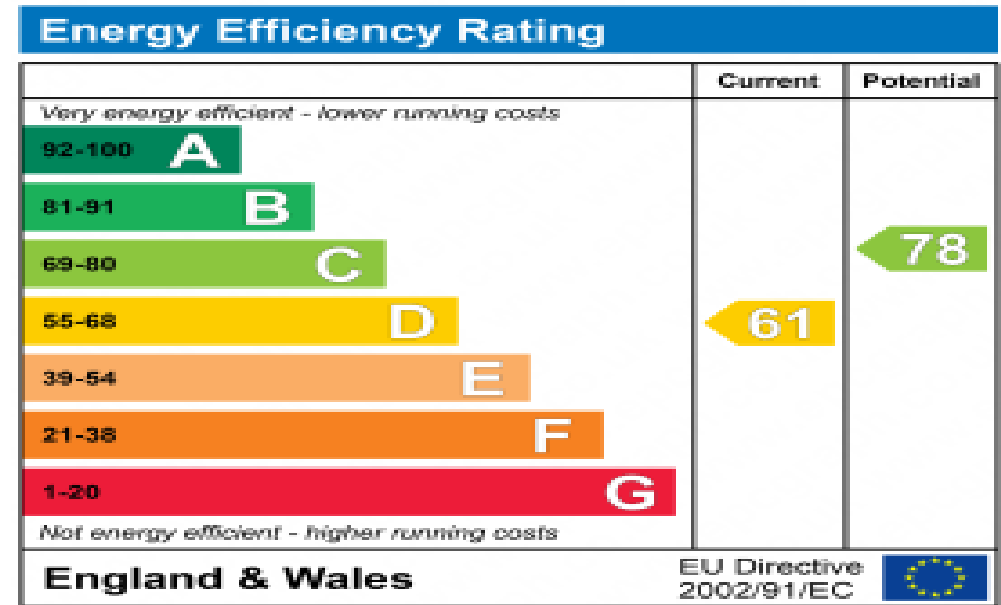

Floor plan

Approximate Area = 3054 sq ft / 283.7 sq m
Garage = 167 sq ft / 15.5 sq m
Total = 3221 sq ft / 299.2 sq m
For identification only - Not to scale

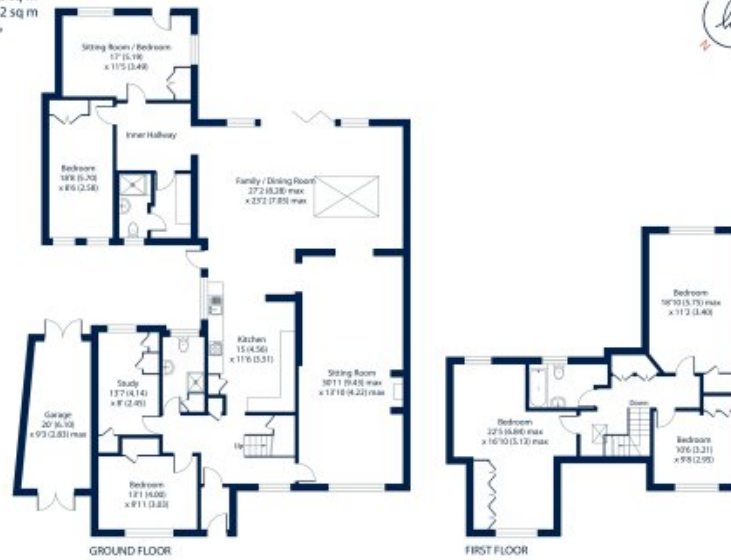

Floor plan produced in accordance withRICS Property Measurement 2nd Edition.

Location

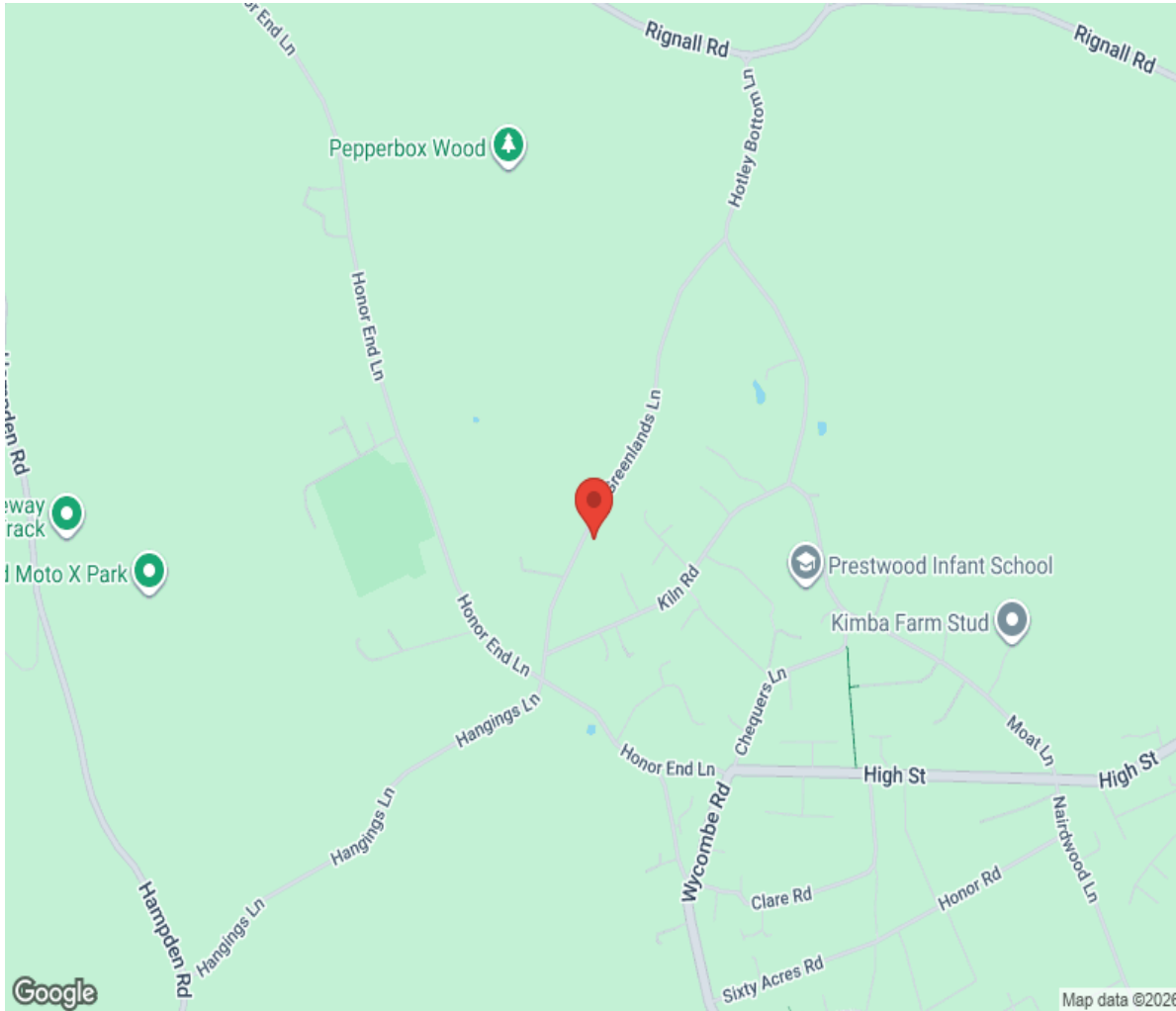

Hamptons

INTERNATIONAL

+44 (0)20 8618 4551

international@hamptons.co.uk

www.hamptons-international.com