

Hamptons

INTERNATIONAL



14104 22nd Terrace E, Bradenton, FL 34212

4  3 

£710,000

(\$975,000)

Property details



14104 22nd Terrace E, Bradenton, FL 34212

4 3

£710,000
(\$975,000)

Key features

- **Sewer: Public**
- **Pool Description: Pool**
- **Garage Count: 5 + Car Garage**
- **Cooling: Central A/C**
- **Water: City Water**
- **Special Program: Global Luxury**

Attributes

- Swimming pool**
- Garage**

Description

Under contract-accepting backup offers. BRING Your toys, Cars, BOAT and RV! Plenty of room with an OVERSIZED 3 car attached garage and a MASSIVE detached 2 car garage! Spacious Mill Creek Retreat with Dual Garages, Pool & Chef's Kitchen Almost 3/4 of an acre in a cul-de-sac in the highly desirable Mill Creek community, this beautifully maintained 4-bedroom, 3-bathroom home offers the perfect blend of functionality and space-inside and out. Enjoy the flexibility of an oversized three-car ATTACHED garage plus an oversized two-car DETACHED garage (Two Driveways) -ideal for your hobbies, workshop, boat, or extra storage. The sparkling pool is the centerpiece of the backyard and can be enjoyed from the comfort of the eat-in kitchen framed by an aquarium glass window. The chef's kitchen features a large island, double ovens, a wine cooler, a walk-in pantry and additional closet pantry-perfect for entertaining or everyday living. The home's thoughtful split-bedroom design includes a spacious primary suite with double walk-in closets with custom closet system and private bath. Additional highlights include fresh interior paint, a formal dining room, large laundry room, and an open layout filled with natural light. And with a brand new roof (2025), peace of mind comes standard. Low HOA, no CDD fees, and a serene location make this Mill Creek gem a rare find.



















































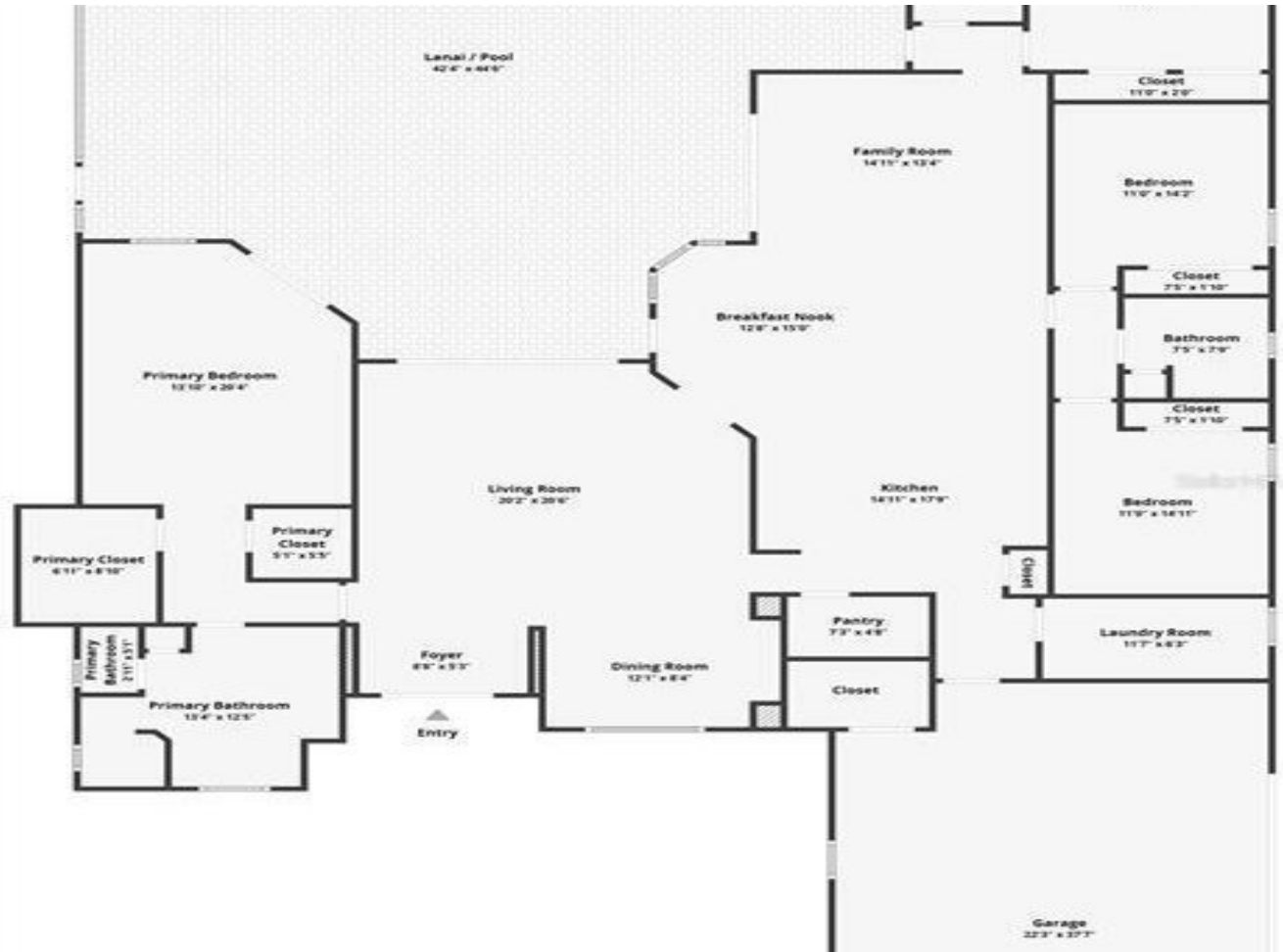























Location

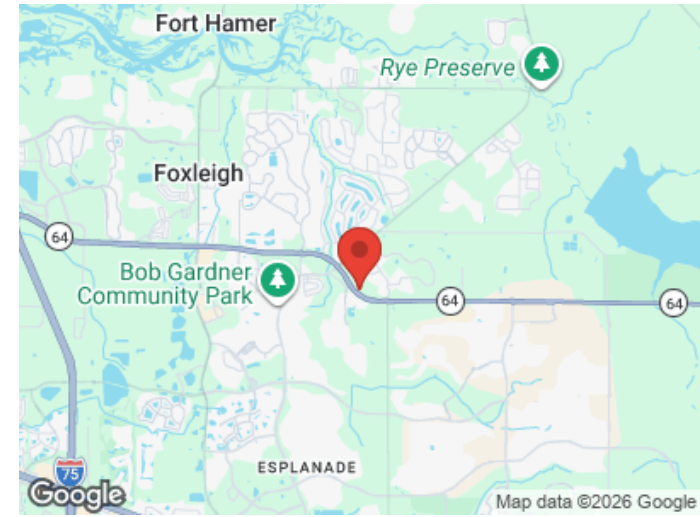
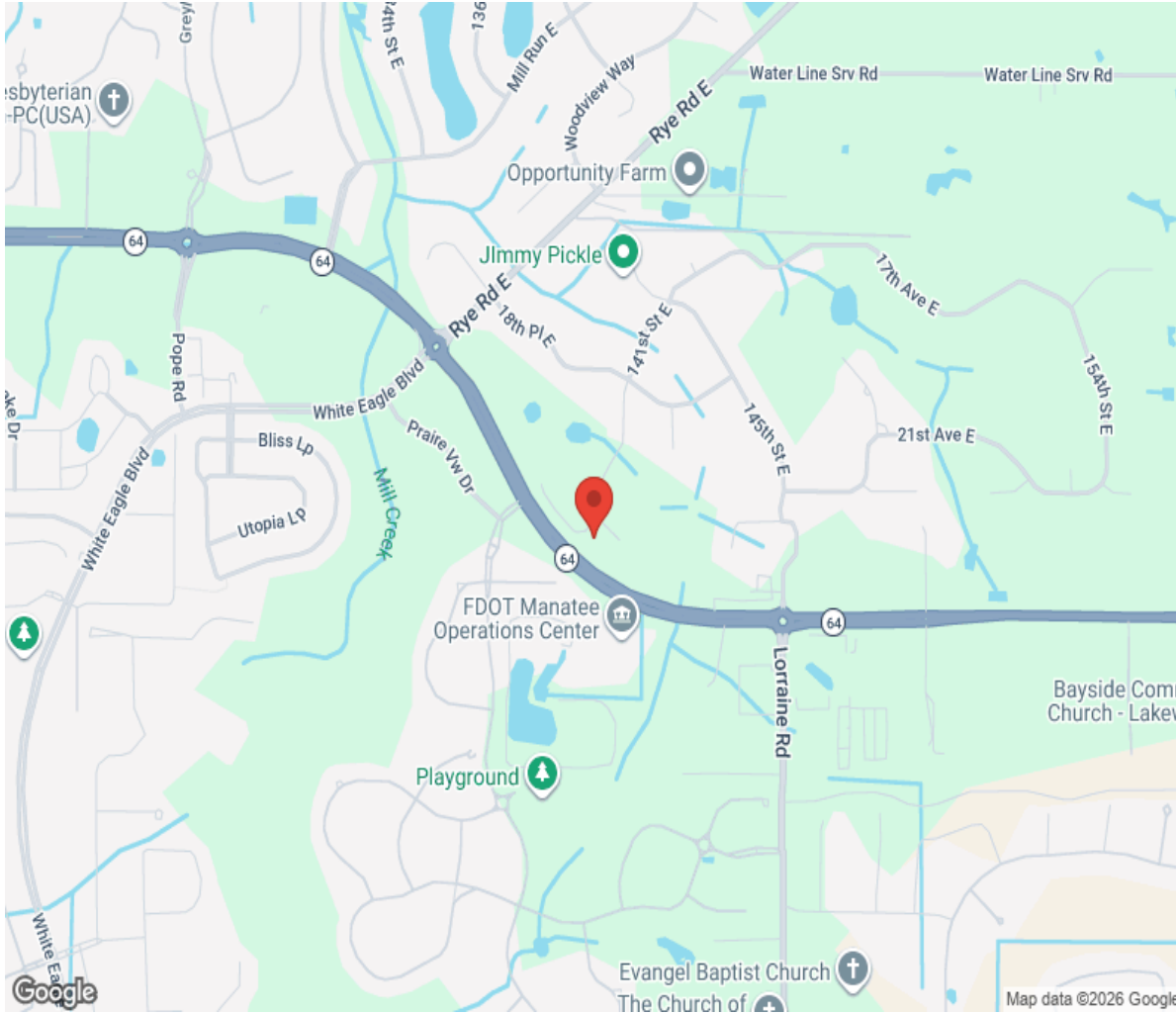

Hamptons

INTERNATIONAL

+44 (0)20 8618 4551

international@hamptons.co.uk

www.hamptons-international.com