

Hamptons

INTERNATIONAL



St Georges Wharf London SW8

3  3  2 

£30,000

(£21,666)

Property details



Attributes

- Apartment

St Georges Wharf London SW8

3 3 2

£30,000
(£21,666)

Description

WATERSIDE - With over 3300 square feet of lateral accommodation this exceptional three bedroom apartment is situated on the 33rd floor of the iconic Tower development in St Georges' Wharf, Vauxhall. Featuring a stylish interior with beautiful furnishing the accommodation offers the resident luxurious accommodation and access to residents amenities including business centre, cinema room, leisure suite including swimming pool. The experienced concierge team provide convenience, security and valet parking and there are iconic views across the London sky-line. To check broadband and mobile phone coverage please visit Ofcom here ofcom.org.uk/phones-telecoms-and-internet/advice-for-consumers/advice/ofcom-checkerThis property is featured by our Waterside department.SituationIn a prominent riverside development various amenities are on site including a pharmacy and mini-market. Further retail amenities, restaurants and leisure facilities can be found a Battersea Power Station close adjacent to Nine Elms Station (Northern Line, 0.4 miles). The most proximate access to the London Underground is via Vauxhall Station (Victoria Line, 0.2 miles).3300 Square FeetResidents Gym and Swimming PoolBusiness Centre and LoungeResidents Cinema RoomSemi-Open Plan Living SpaceHigh Specification KitchenThree BedroomsThree Luxury BathroomsGuest CloakroomValet parking



















Energy Efficiency Rating

EPC Pending

England & Wales

EU Directive
2002/91/EC



Floor plan

THE UPPER

Approximate Gross Internal Area
3370 sq. ft. (313.1 sq. m.)

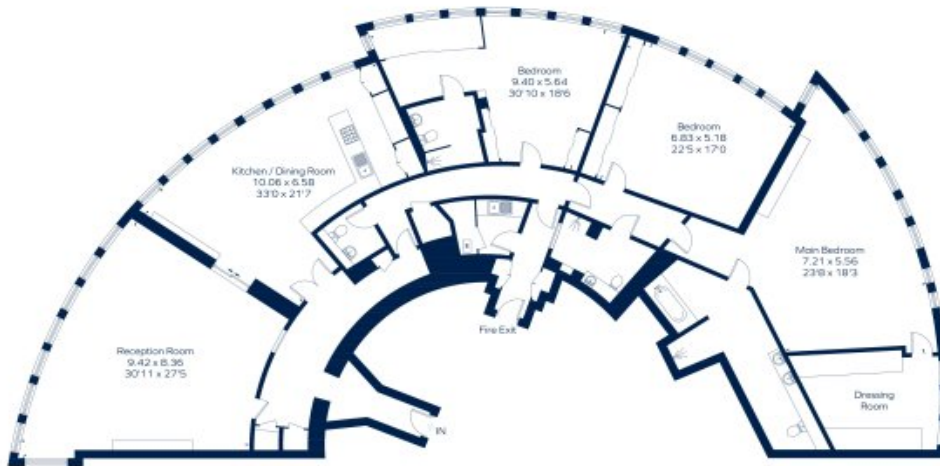

Thirty Third Floor

Drawn for illustration and information purposes only.

Location



Hamptons

INTERNATIONAL

+44 (0)20 8618 4551

international@hamptons.co.uk

www.hamptons-international.com