



# Hamptons

INTERNATIONAL



## Acton Walk, Whetstone, N20

2  2  1 

GUIDE PRICE

**£540,000**

**(£535,000)**

## Property details



### Key features

- **Seventh Floor**
- **Lift or Stairs**
- **Lounge Area with Summer Balcony**
- **Two Double Bedrooms**
- **Large Laundry/Storage Cupboard**
- **Winter Garden to Bedrooms & Loun**
- **Communal Roof Garden**
- **Parking Space**
- **Wet underfloor heating**
- **Wired for HD Television**

### Attributes

- **Apartment**

## Acton Walk, Whetstone, N20

GUIDE PRICE  
**£540,000**  
**(£535,000)**

2 🏠 2 🚗 1 📺

## Description

Positioned on the seventh floor of the striking Northway House development, this beautifully appointed two-bedroom, two-bathroom apartment offers contemporary living with outstanding far-reaching views across London and breathtaking sunsets from dual aspects. Positioned on the seventh floor this beautifully appointed apartment offers contemporary living with outstanding far-reaching views across London. Accessed via lift or stairs, the apartment overlooks a landscaped green roof and benefits from both a summer balcony and a winter garden—a full-height glazed enclosure that can be fully opened, providing flexible year-round indoor-outdoor living. The spacious open-plan living, kitchen and dining area is finished to a high standard, featuring sleek contemporary cabinetry, quartz worktops and a full suite of integrated Smeg appliances, including an oven, induction hob, microwave grill, fridge/freezer, dishwasher and built-in wine cooler. The hallway includes a large utility cupboard with washer/dryer. The principal bedroom is fitted with a soft-close wardrobe and a stylish en-suite shower room, while the luxury family bathroom is finished in elegant porcelain stoneware tiles. Both bathrooms reflect the apartment's refined, modern aesthetic. Outside the property also benefits from one secure allocated parking space within an electronically gated car park. Residents enjoy access to a stunning top-floor communal roof garden, offering uninterrupted panoramic views across London—an ideal space for relaxation or entertaining. Located in the vibrant heart of Whetstone High Road, Northway House is surrounded by an excellent selection of restaurants, cafés and shops including Waitrose, M&S Food and Boots. Brook Farm Open Space is within easy walking distance, as are excellent transport links: Oakleigh Park station for fast trains to King's Cross and Moorgate, Totteridge & Whetstone on the Northern Line, along with multiple bus routes. Property Ref Number: HAM-43718

**Additional Information** A superb opportunity to enjoy stylish, well-connected London living in a prime location.













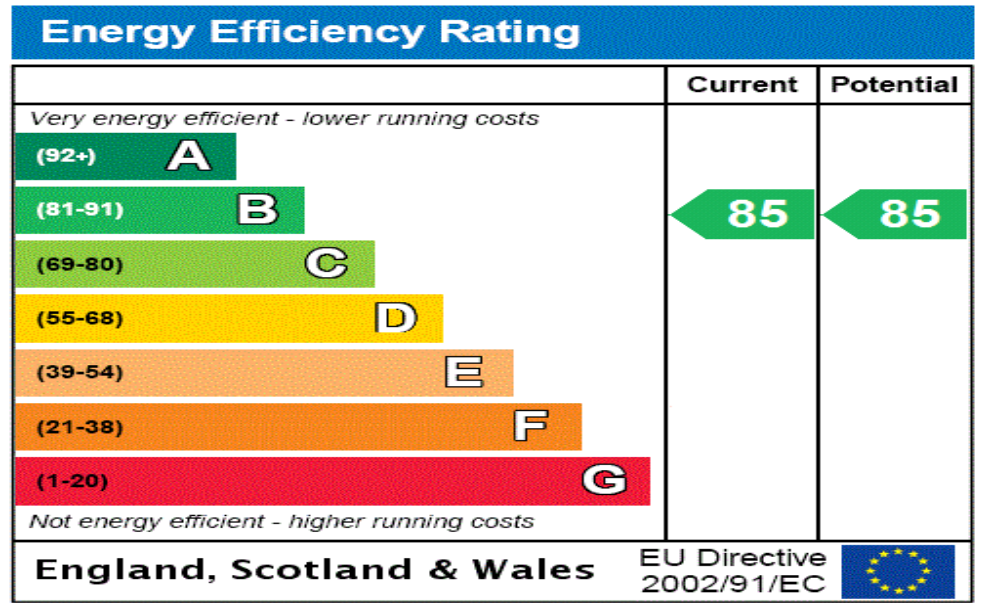

# Floor plan

## NORTHVIEW HOUSE

Approximate Gross Internal Area

775 sq. ft. (72 sq. m.)

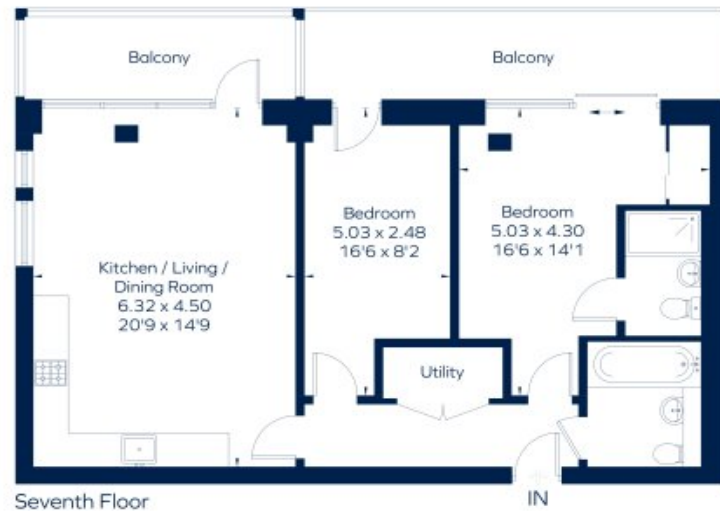

Seventh Floor

This plan is for layout guidance only. Not drawn to scale unless stated. Windows and door openings are approximate. All the every room is taken in the construction of this plan. Please check all dimensions, doors and windows before making any decisions about your home.

# Location

---

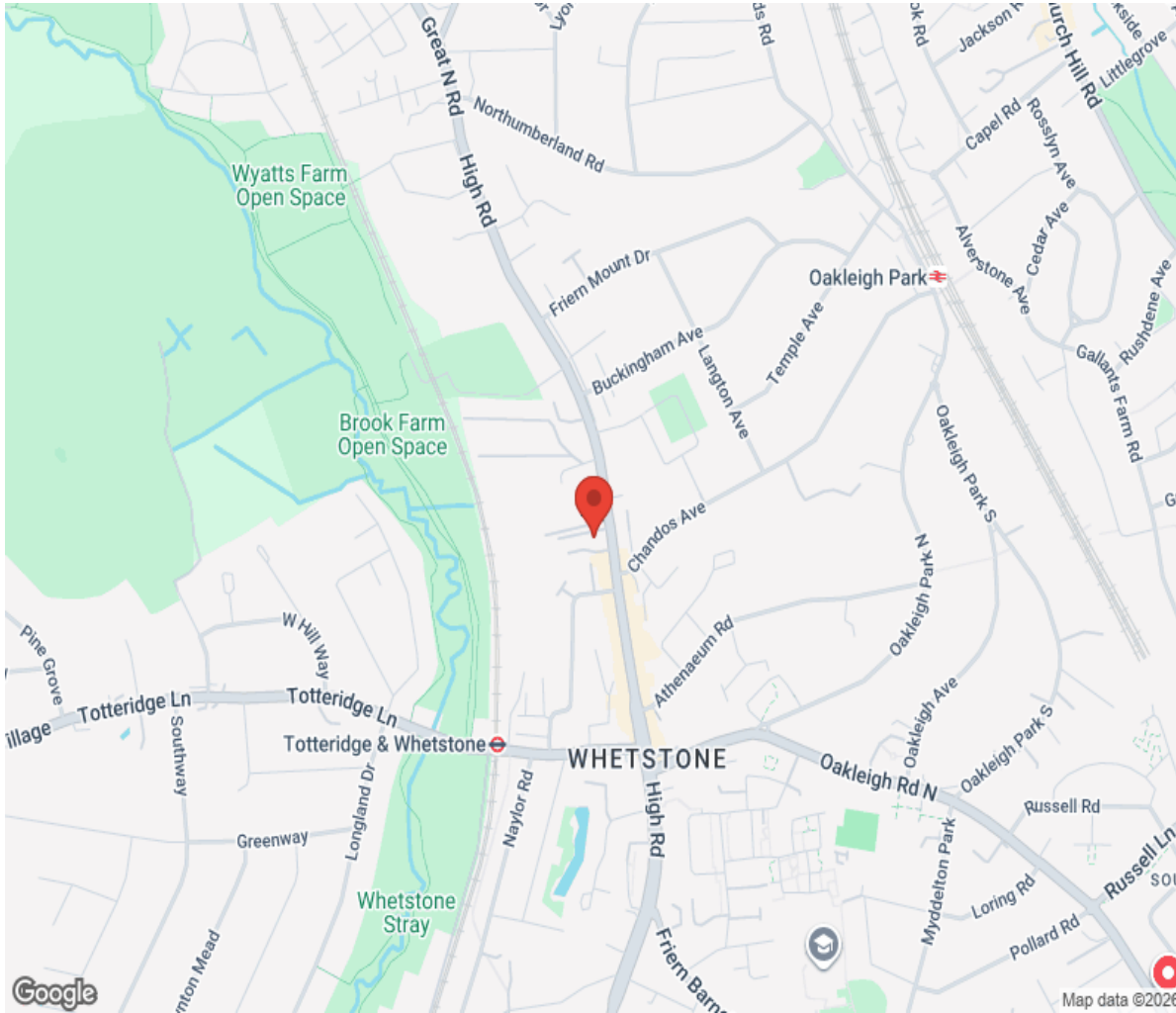

# Hamptons

INTERNATIONAL

**+44 (0)20 8618 4551**

**[international@hamptons.co.uk](mailto:international@hamptons.co.uk)**

**[www.hamptons-international.com](http://www.hamptons-international.com)**