

Hamptons

INTERNATIONAL



560 Allentown Rd, Troy Hills, NJ 07054

5 𠄎 5 𠄎

£1,040,000

(\$1,399,000)

Property details



Key features

- **Garage Count: 2 Car Garage**
- **Heating - Fuel Type: Gas**
- **Sewer: Public**
- **Fireplace Count: 1 Fireplace**
- **Water: City Water**
- **Special Program: Global Luxury**

560 Allentown Rd, Troy Hills, NJ 07054

5 🏠 5 📄

£1,040,000
(\$1,399,000)

Description

Welcome to your dream home, beautiful new construction right in the heart of Lake Parsippany, built by a highly regarded local builder known for quality craftsmanship. From the moment you arrive, you'll love the curb appeal, complete with a charming paver walkway leading from the driveway to the front door. Step inside to a bright two-story foyer and gorgeous hardwood floors that flow throughout the home. The white shaker-style kitchen cabinets with quartz countertops open seamlessly to a spacious family room featuring a cozy gas fireplace and sliders to a Trex deck, perfect for effortless indoor-outdoor living. Hosting a dinner party? The dining room shines with a coffered ceiling and high-end moldings. A first-floor bedroom provides flexibility and is ideal as a potential in-law suite, while the formal living room offers additional versatility as a home office or gathering space. Upstairs, you'll find four generously sized bedrooms, including a dreamy primary suite featuring one huge walk-in closet with custom built-in shelving plus two additional closets for exceptional storage, along with a spa-like bath. The finished basement offers even more space to relax, entertain, or host guests, complete with a full bathroom. Thoughtfully designed and filled with natural light, this home blends style, comfort, and convenience in every detail. Conveniently located with access to top-rated schools, major highways, and everyday amenities. This is everything you've been waiting for!

Bedroom 21.0ft x 25.0ft Bedroom 12.0ft x 13.0ft Bedroom 12.0ft x 12.0ft Bedroom 12.0ft x 13.0ft Dining Room 12.0ft x 14.0ft Family Room 17.0ft x 23.0ft Kitchen 20.0ft x 14.0ft Living Room 12.0ft x 16.0ft





110549







410549





110549

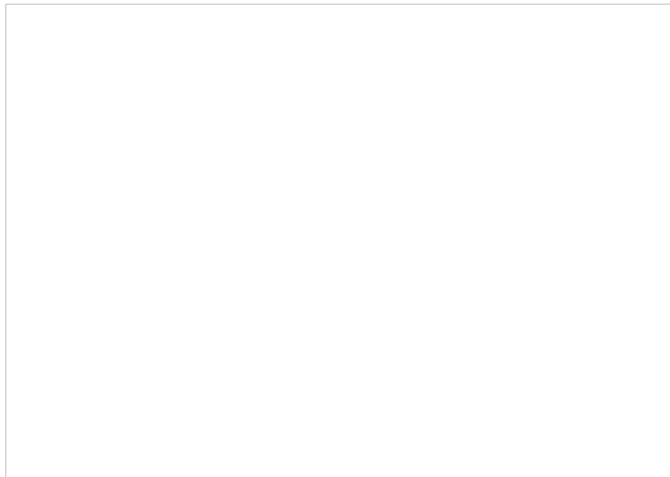



110549









10549



549

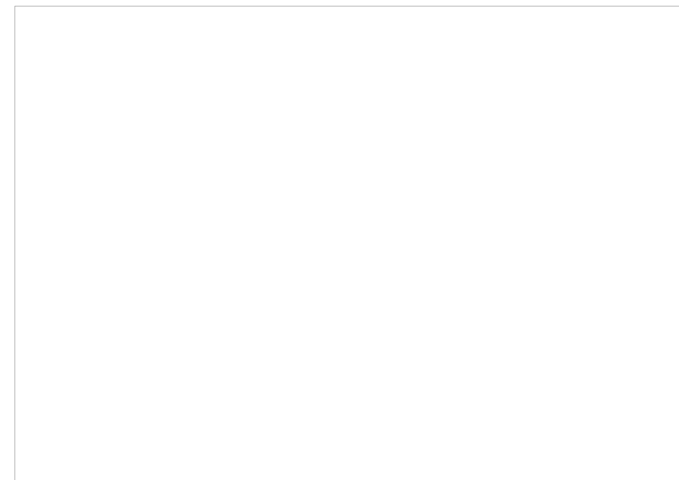

FIRST LEVEL

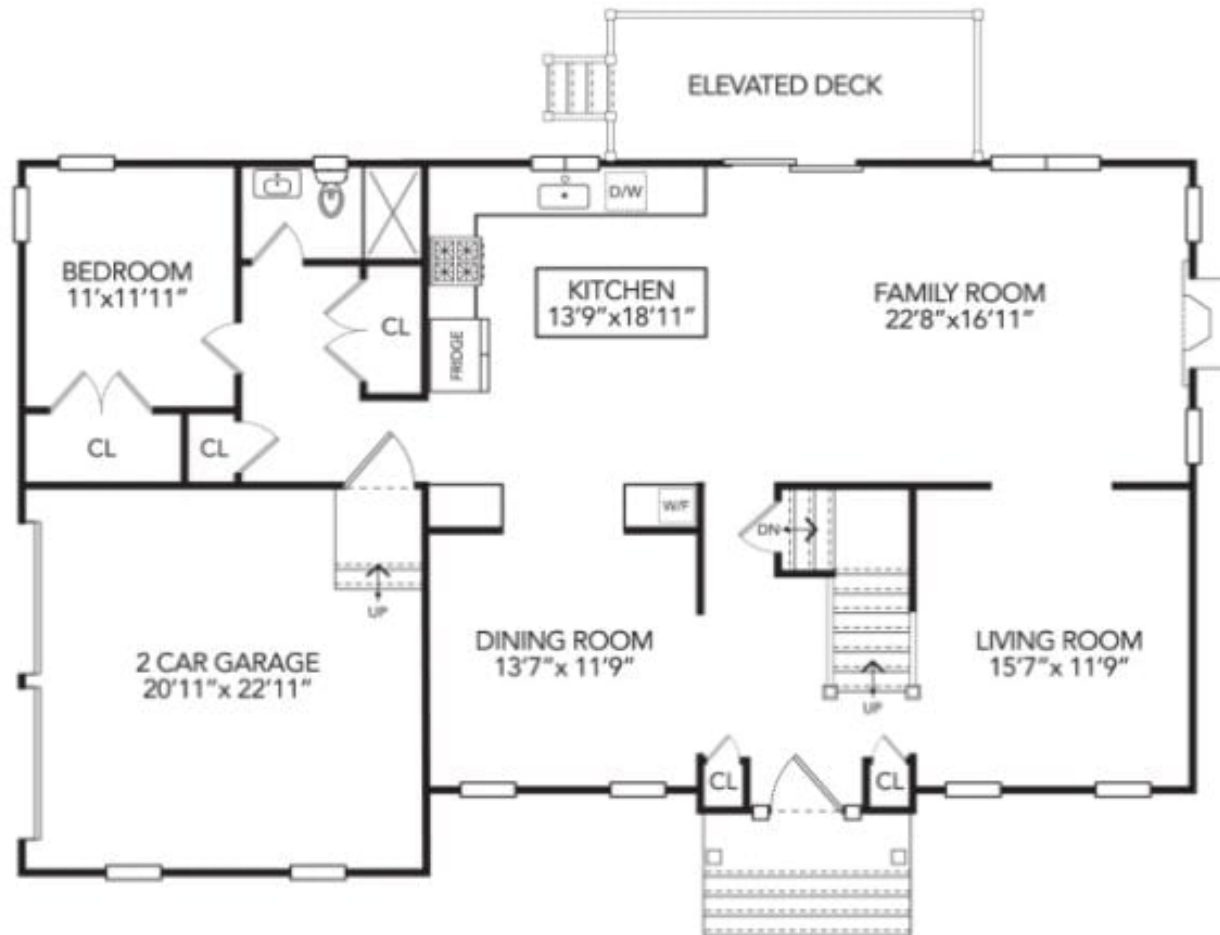

PLEASE NOTE - NOT TO SCALE - This floor plan is for illustration purposes only.
Rooms and dimensions are approximate and should be independently verified by the buyers for accuracy.

Location

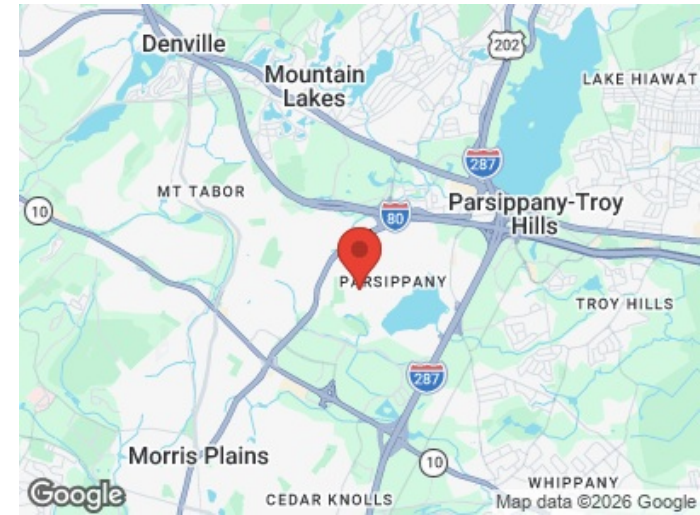
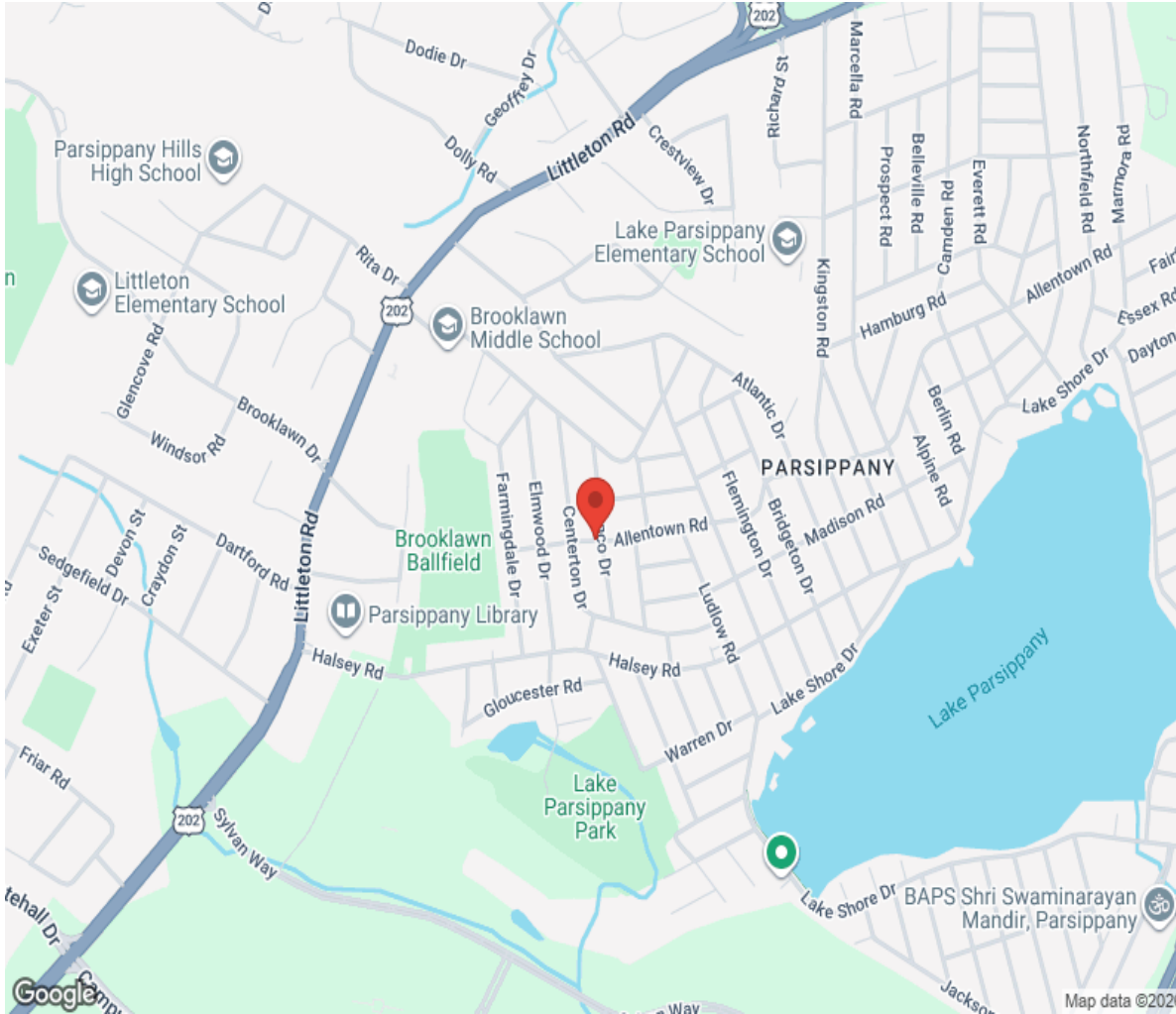

Hamptons

INTERNATIONAL

+44 (0)20 8618 4551

international@hamptons.co.uk

www.hamptons-international.com