

Hamptons

INTERNATIONAL



Kings Meadow, Whyteleafe Hill, Whyteleafe, CR3

2  1 

GUIDE PRICE

£480,000

(£475,000)

Property details



Key features

- Show Home Open-please call to book
- Two Double Bedroom with Fitted W
- Ground Floor Overlooking Landscap
- Luxury Kitchens with Quartz Workto
- High Specification Bathroom with P
- Separate Utility Cupboard
- Highly Secure with Gated Entrance
- Set within 40 Acres of Landscaped

Attributes

- Apartment

Kings Meadow, Whyteleafe Hill, Whyteleafe, CR3 GUIDE PRICE

£480,000

(£475,000)

2 🏠 1 📄

Description

A well-appointed two bedroom, ground floor apartment located in the 'Spitfire Wing' at Kings Meadow. The Show Home is open—register your interest to secure your private appointment. The Spitfire Wing, part of the estate's original architectural fabric, has been elegantly restored and reimaged to create twelve beautifully crafted one and two-bedroom apartments. Apartment 2 is a ground-floor two-bedroom home enjoying views across the landscaped communal grounds. Both bedrooms are generously sized and include fitted wardrobes, while the high-specification bathroom features Porcelanosa sanitaryware, integrated mirrored cabinetry and a heated, illuminated vanity mirror. The double-aspect open-plan kitchen, dining and living area offers a versatile space. The kitchen is thoughtfully designed with durable quartz worktops, resistant to heat, stains and scratches and includes premium Miele integrated appliances. A separate utility cupboard provides added practicality. There is zoned underfloor heating throughout with Herringbone engineered timber flooring to the main living areas, tiles in the bathrooms and carpets fitted to the bedroom areas. Kings Meadow is accessed via a private road and secured with electronic gated entry and an intercom system to each apartment. CCTV coverage throughout the communal areas ensures additional reassurance and peace of mind. Kings Meadow marks the new, exciting chapter of the former Victorian estate of Flintfields and later used as the Officers' Mess at RAF Kenley during the Second World War. Throughout the development, every detail has been carefully considered to restore and preserve the architectural integrity of the original buildings. Now transformed into a collection of 53 beautifully designed apartments, ranging from one to three-bedrooms, along with two unique mews houses and the restored Gate Lodge. Residents will enjoy exclusive on-site amenities including the Lounge and Library; a space for residents to unwind, socialise, welcome their guests, or work from home. Set within 40 acres of landscaped communal grounds, Kings Meadow also features a Gym and Racquets Sports Hub as well as the opportunity to secure your own allotment (limited basis). Situation Kings Meadow is ideally positioned just off Whyteleafe Hill and directly beside the open expanse of Kenley Aerodrome. The setting provides direct access to nature trails through Kenley Common and Coulsdon Common, perfect for walkers, cyclists, and wildlife enthusiasts. The development is ideally placed with convenient access to the M25, connecting journeys to London, Gatwick Airport and the South Coast. Caterham town centre is just 1.3 miles distant with a mainline station, plenty of cafes and restaurants and varied high street shopping. The development is well connected to local transport links. Whyteleafe train station (0.7 miles) and Upper Warlingham (0.9 miles) have direct services to London Victoria in as little as 30 minutes. There will be a bus stop adjacent to the development entrance providing access to the local areas as well as further afield Reigate, South Croydon, Godstone. Property Ref Number: HAM-63318 Additional Information*Please note photography is a variation of the show home and computer generated images. Service Charges 2026: to be confirmed Show Home Open - book to view





Floor plan

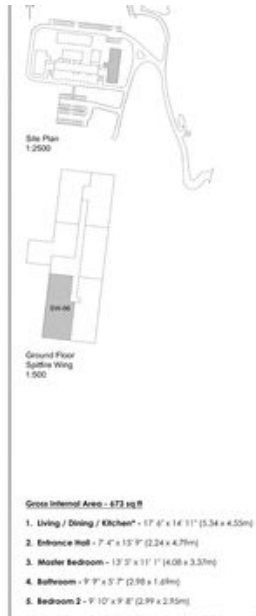

KING'S MEADOW

Hamptons
THE HOME EXPERTS

Project: KING'S MEADOW

Prop: SPITFIRE WING
GROUND FLOOR
APARTMENT 6 (SW-06)

TYPE	NEW
STATUS	FOR SALE
PRICE	£495,000
DATE	12/08/2024

IPG



Location

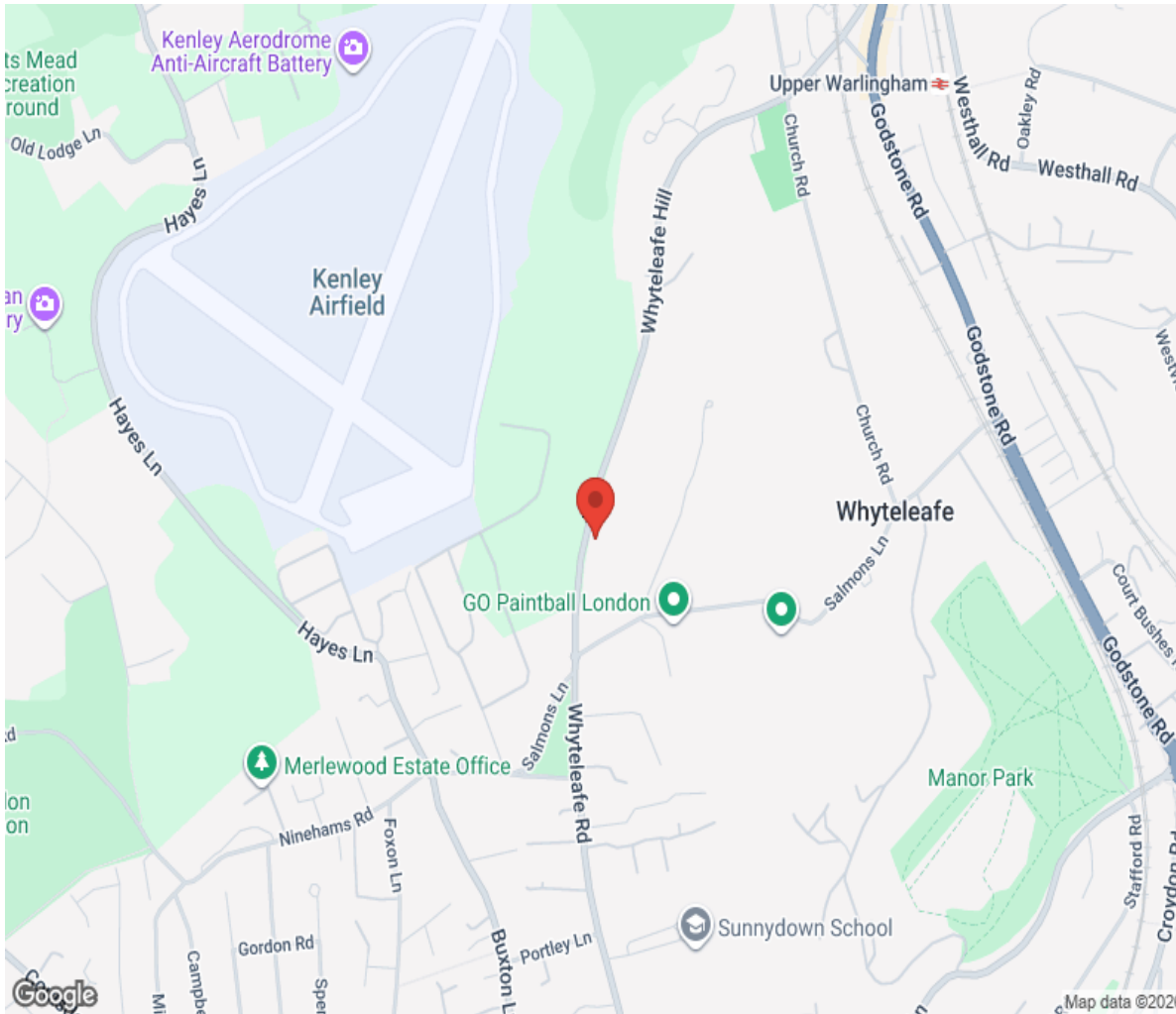

Hamptons

INTERNATIONAL

+44 (0)20 8618 4551

international@hamptons.co.uk

www.hamptons-international.com