

# Hamptons

INTERNATIONAL



**Putney Heath, London, SW15**

4  2  2 

**£900,000**

(£900,000)

## Property details



### Key features

- **Mansion Block Apartment**
- **Fully Refurbished**
- **Four Bedrooms**
- **Reception Room**
- **Kitchen**
- **Two Bathrooms**
- **Private Balcony**
- **Communal Grounds**
- **Lift Access**
- **No Onward Chain**

### Attributes

- **Apartment**

**Putney Heath, London, SW15**

4 2 2

**£900,000**  
**(£900,000)**

## Description

A well presented mansion block apartment, offering 1,538 square foot of lateral accommodation, private balcony and extensive communal grounds. A fantastic third floor apartment in the popular Exeter House development. The apartment is presented to a high standard throughout and offers exceptional lateral accommodation with wonderful natural light. The property is accessed by either staircase or lift. Internally, the accommodation is set off a central entrance hall. The bright reception room is of generous proportion and enjoys a dedicated dining area and doors opening to the South facing private balcony. Across the entrance hall is the modern kitchen, presented in excellent order and featuring a range of built in appliances. There is ample storage, along with an external rear entrance with porters' lift. There are three generous double bedrooms and a further fourth bedroom, all with built in wardrobes. The flat benefits from a well appointed shower room and, as with the rest of the property, a newly fitted family bathroom. Situation The grounds at Exeter House are a huge draw for residents, with extensive lawns, beautifully maintained gardens, two tennis courts, barbecue and outdoor entertaining space, along with a children's play area. There is an on-site estate manager and residents benefit from off street parking. The development is situated halfway along Putney Heath and faces the Heath. Bus stops serving Exeter House include routes 85, 170, 424 and 493 giving access to Putney High Street, Richmond, Kingston and Victoria. Putney mainline train station and East Putney tube station are also easily accessible. Property Ref Number: HAM-63570

















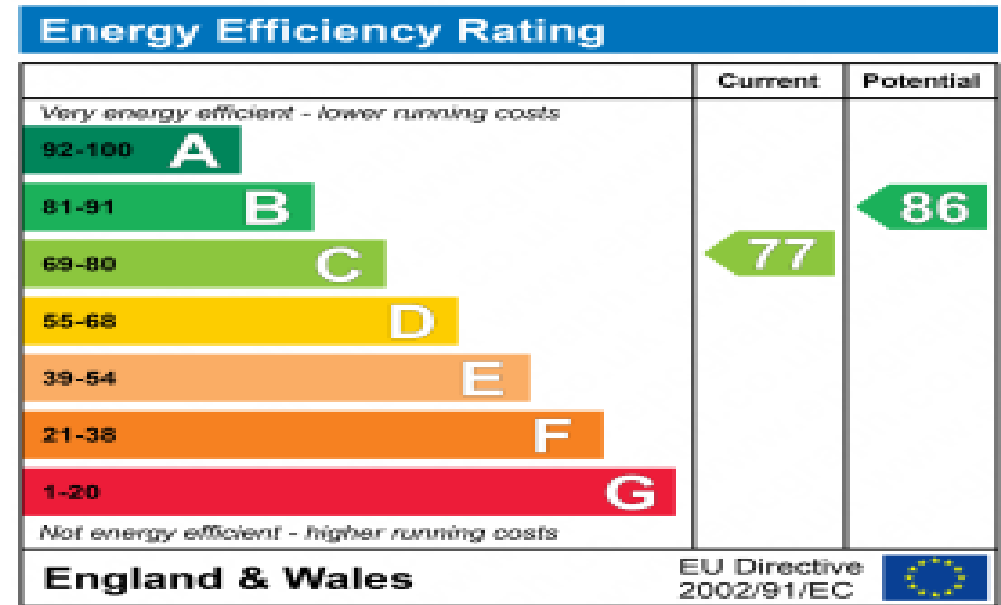

# Floor plan

## EASTER HILL 06

Approximate Gross Internal Area

1538sq. ft. (142.9 sq. m.)

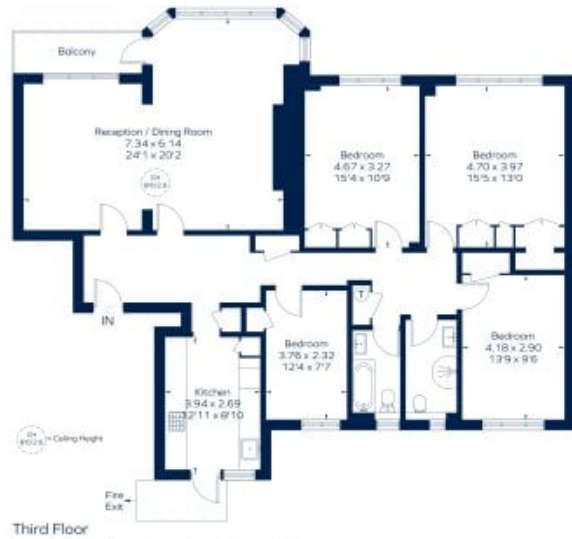

Third Floor

This plan is for layout guidance only. No dimension scale unless stated. Windows and floor openings are approximate. All fit every room to follow in the preparation of this plan, please check all dimensions, doors and cupboard openings before making any decisions upon them.

# Location

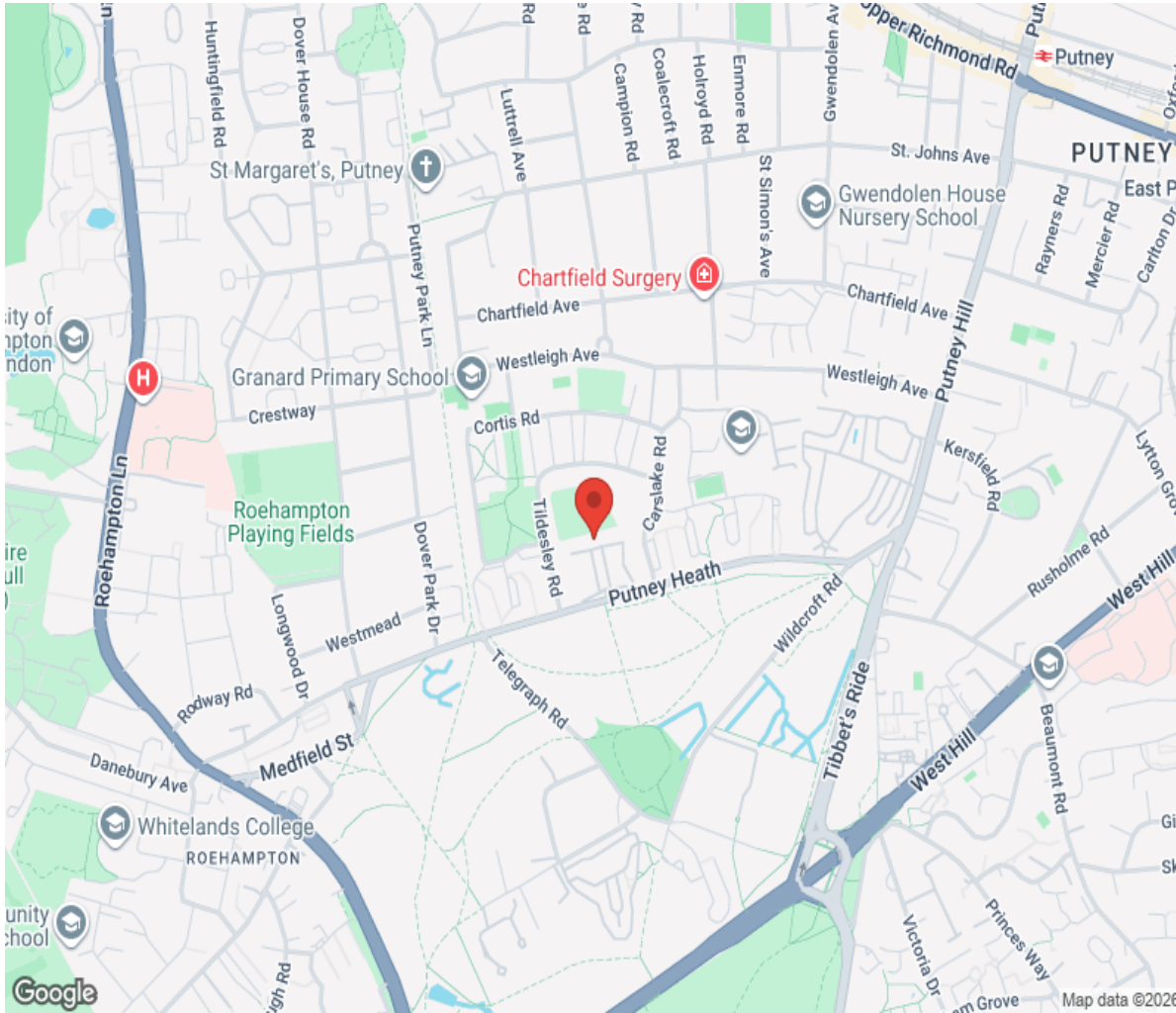

# Hamptons

INTERNATIONAL

**+44 (0)20 8618 4551**

**[international@hamptons.co.uk](mailto:international@hamptons.co.uk)**

**[www.hamptons-international.com](http://www.hamptons-international.com)**