

Hamptons

INTERNATIONAL



Petersham Road, TW10

2  2  1 

£10,000

(£3,600)

Property details



Attributes

- Apartment

Petersham Road, TW10

2 🏠 2 🚗 1 📺

£10,000
(£3,600)

Description

The property is neutrally decorated throughout and comprises a reception with space for dining leading through to the kitchen/breakfast room, two double bedrooms both benefitting from built-in wardrobes and en-suite bathrooms. The property further benefits from a separate cloakroom, private roof terrace and an off-street parking space. To check broadband and mobile phone coverage please visit Ofcom here [ofcom.org.uk/phones-telecoms-and-internet/advice-for-consumers/advice/ofcom-checker](https://www.ofcom.org.uk/phones-telecoms-and-internet/advice-for-consumers/advice/ofcom-checker) Situation The property is located close to the amenities of Richmond and the residents of the development have direct access to the riverside gardens through a private tunnel, also to the rear of the development is a residents' gate which allows access to Terrace Gardens which sweep upwards to Richmond Hill. Two bedrooms Two bathrooms Reception room Kitchen/breakfast room Cloakroom Roof terrace Off-street parking Council Tax Band G













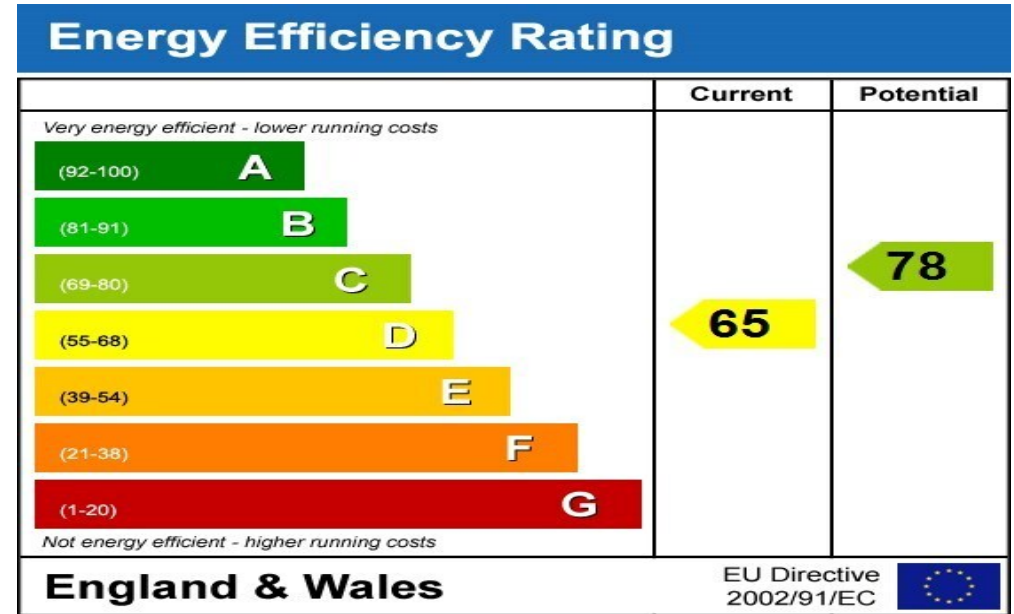

Floor plan

Ground Floor = 1270 sq. ft. (118 sq. m.)

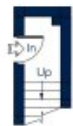

Ground Floor

First Floor

Location

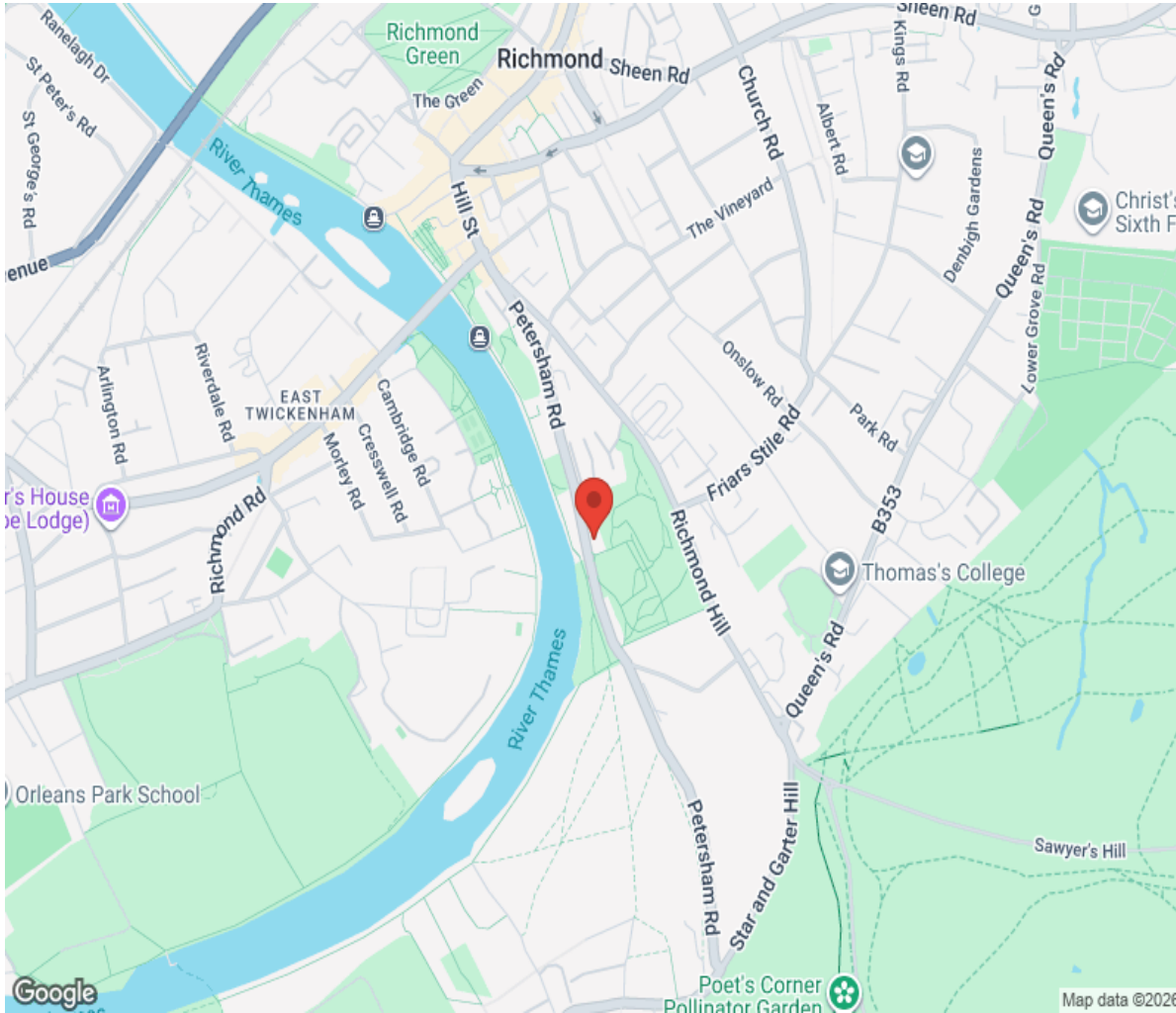

Hamptons

INTERNATIONAL

+44 (0)20 8618 4551

international@hamptons.co.uk

www.hamptons-international.com