

Hamptons

INTERNATIONAL



Clubhouse Residences, Craven Road, London, W5

5 𠄎 5 𠄎

£1,800,000

(£1,795,000)

Property details



Key features

- **Five-bedroom family home**
- **Energy efficient design**
- **Prime Ealing location**
- **Exceptional transport links**
- **Premium specification**
- **Parking with each home**

Clubhouse Residences, Craven Road, London, W5

£1,800,000

(£1,795,000)

5 🏠 5 📄

Description

Where contemporary design meets family living. Five bedrooms, multiple floors of entertaining space, and high-quality finishes throughout this exclusive Clubhouse Residences home. Contact us to find out more. Step inside our exquisite show home at Clubhouse Residences, now available to view. Book an exclusive viewing with Hamptons today. Clubhouse Residences is a boutique development of six contemporary light-filled houses with high-quality fixtures and finishes, located in one of London's best-loved residential areas. Brought to you by Luxgrove Homes, a specialist boutique developer with a proven track record of delivering exceptional homes across West London. The open plan living spaces seamlessly blend timeless interior details with practical comfort. Feel true comfort through thoughtful lighting, warm and hard-wearing materials, and practically arranged layouts. In this development we've paired natural oak veneer cabinets with timeless but durable engineered stone worktops in a timeless Calacatta marble design along with built-in Miele appliances. The kitchen is truly the heart of the home and we've made sure that it's both comfortable for everyday use as well as the perfect place for entertaining guests. With fumed oak flooring and underfloor heating throughout, your home will be a haven of comfort and cosiness, especially on those cooler winter days. All of our bedrooms have high quality prefitted wardrobes and super-soft carpets. Master bedrooms also have tasteful fitted bedside wall lights. Outside Each house boasts a private landscaped garden with external lighting, perfect for outdoor entertaining and family living. Situation Nestled on the peaceful Craven Road in Ealing W5, Clubhouse Residences offers the best of both worlds - a quiet, tree-lined setting just moments from the bustling heart of Ealing Broadway, one of West London's most sought-after neighbourhoods. Ealing Broadway station is just a 12-minute walk or 8-minute bus ride away, providing exceptional connectivity via the Elizabeth Line, Central Line, and District Line. Reach Paddington in 11 minutes, Bond Street in 15 minutes, and Canary Wharf in 27 minutes. Heathrow Airport is a convenient 22 minutes away, making this an ideal location for both commuters and frequent travellers. Major roads including the A406 and Uxbridge Road are easily accessible for drivers. The vibrant Ealing Broadway area spoils residents with an abundance of choice. The Ealing Broadway Shopping Centre and stylish Dickens Yard development offer high-street retailers, independent boutiques, and fitness facilities. Food lovers will appreciate the diverse dining scene, from the acclaimed Spanish restaurant Rayuela and elegant Côte Brasserie to the trendy Teatro Hall and The Grove gastropub. For everyday essentials, Planet Organic, Waitrose, Sainsbury's, and Marks & Spencer are all within easy reach. Ealing is renowned for its beautiful parks and open spaces. The historic Walpole Park, home to Grade I-listed Pitzhanger Manor and the charming Pitzhanger Pantry café, is perfect for family outings and cultural visits. Ealing Common, Lammas Park, and Ealing Green provide additional green havens for relaxation and recreation, while the Ealing Lawn Tennis Club and Nuffield Health offer excellent sporting facilities. The area is well-served by outstanding educational institutions including St John's Primary, Durston House School, Christ the Saviour C of E Primary, Montpelier Primary, and Twyford C of E High School, making this an excellent choice for families. Often referred to as the "Queen of the Suburbs," Ealing combines village charm with cosmopolitan flair. Whether you're enjoying artisan coffee at WA Café or Black Sheep Coffee, browsing the farmers' market, or catching a film at the local cinema, you'll find everything you need for modern London living right on your doorstep. Property Ref Number: HAM-63912 Additional Information About Luxgrove Homes Delivered by Luxgrove Homes, a developer renowned for creating boutique developments with exceptional attention to detail and quality craftsmanship.





















Floor plan

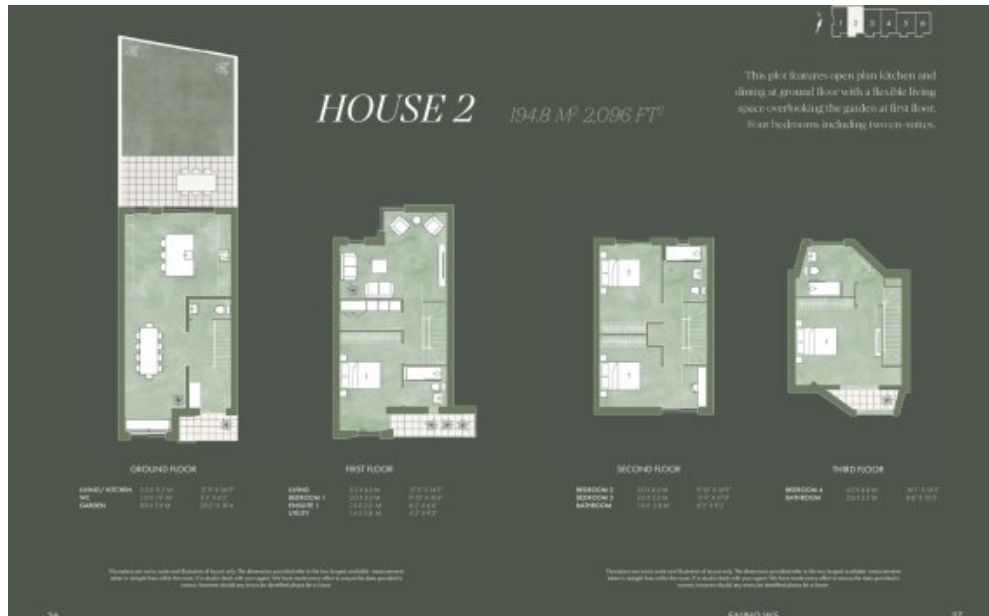

Location

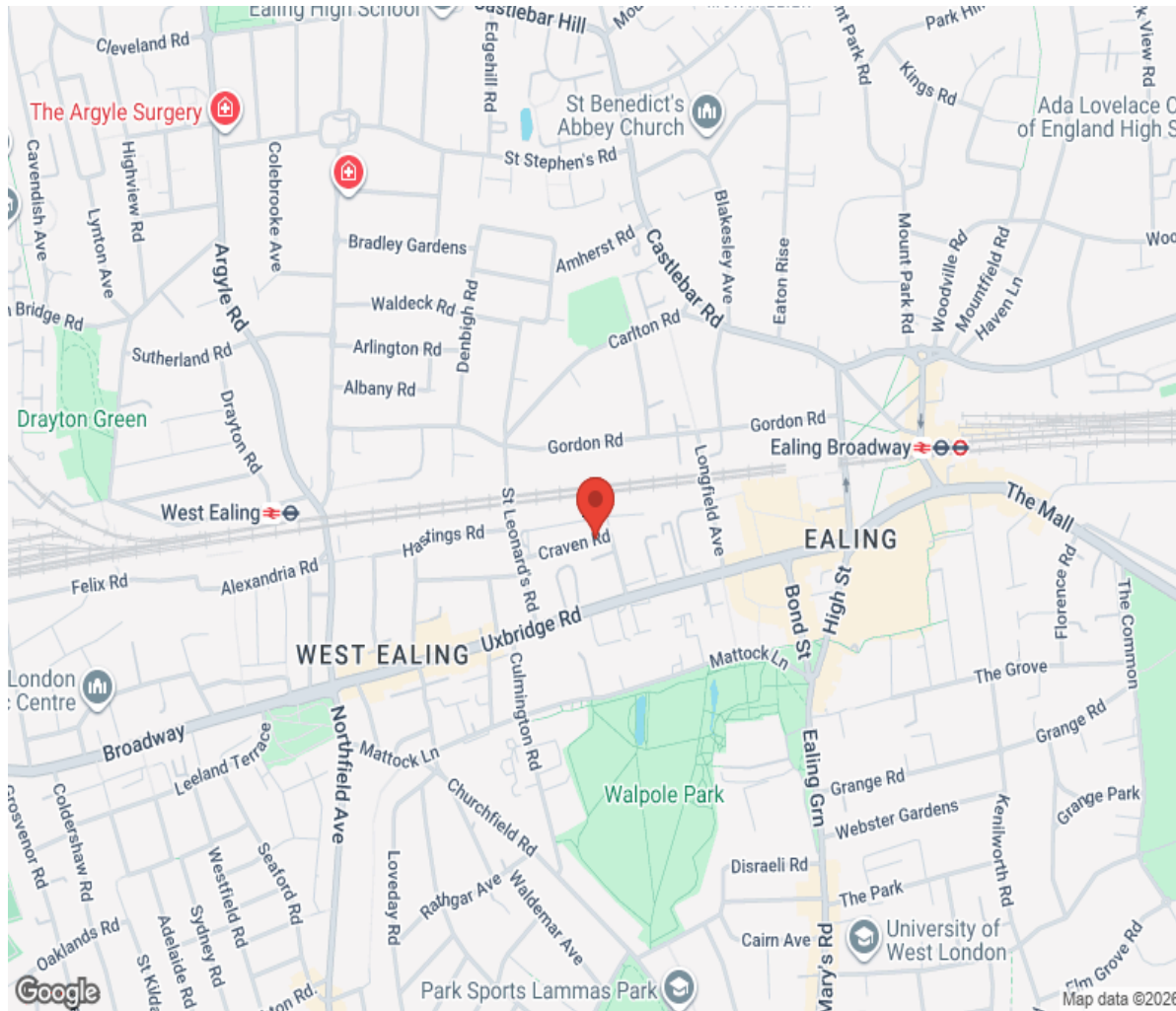

Hamptons

INTERNATIONAL

+44 (0)20 8618 4551

international@hamptons.co.uk

www.hamptons-international.com