

Hamptons

INTERNATIONAL



Manchester Road, London, E14

3  3  1 

GUIDE PRICE

£800,000

(£800,000)

Property details



Key features

- **Three bedroom period home**
- **Set over three floors**
- **Ground floor en-suite bedroom**
- **Semi Open-plan kitchen/reception/c**
- **Sliding doors to Private rear garden**
- **First floor double bedroom with Stc**
- **Contemporary bathroom with wet r**
- **Loft bedroom suite with en-suite**
- **Driveway Parking**
- **Garden room with shower & utilitie**

Manchester Road, London, E14

GUIDE PRICE

£800,000

(£800,000)

3 🏠 3 🚗 1 📧

Description

Guide Price £800,000 to £850,000 A substantial three-bedroom period home arranged over three floors, offering generous and flexible living space. The property features a ground floor bedroom with en-suite, first floor bedroom and bathroom, and top floor loft bedroom suite with en-suite. Further benefits include driveway, private garden, and fully serviced garden room with shower room.

Guide Price £800,000 to £850,000 A substantial and well-presented three-bedroom period home arranged over three floors, offering generous and highly versatile living accommodation throughout. The ground floor features a welcoming reception/dining room with semi open-plan access to a modern fitted kitchen, creating an ideal space for both everyday living and entertaining. Sliding doors lead directly onto the private rear garden. Also on this level is a double bedroom with en-suite shower room, offering excellent flexibility for guests or multi-generational living. The first floor provides a further spacious double bedroom with built-in storage, alongside a beautifully finished contemporary bathroom featuring a wet room style design, separate bath and walk-in shower, complemented by additional integrated storage. The top floor comprises a loft bedroom suite (no dormer), accessed via a staircase, currently used as a generous double bedroom with its own en-suite shower room. Externally, the property benefits from a driveway to the front and a well-maintained rear garden with patio leading onto a lawned area. At the rear sits a fully insulated and serviced garden room, complete with electricity, heating, shower room, walk-in shower, walk-in wardrobe and additional storage, making it ideal as a home office, guest suite or studio space. Offered chain free, this attractive period home combines character, space and modern versatility in a convenient residential setting.

Outside Private rear garden with patio leading onto lawn, providing a pleasant outdoor space for relaxing and entertaining. At the rear is a fully insulated garden room with power, heating and water, currently arranged with a shower room, walk-in wardrobe and storage, offering versatile use as a home office, guest suite or studio. The property also benefits from a driveway providing off-street parking to the front.

Situation Situated just a short walk from Island Gardens DLR, offering quick access to Canary Wharf and the City. The Greenwich foot tunnel is also close by, giving easy pedestrian access to Greenwich with its range of shops, riverside walks, and green spaces. Nearby Masthouse Terrace Pier provides Thames Clipper river boat services into central London, offering a scenic and convenient commuting option. Property Ref Number: HAM-64622

Additional Information From Canary Wharf, residents benefit from direct connections to the Jubilee and Elizabeth lines, providing fast access to the West End, Heathrow Airport, and London City Airport. Canary Wharf also offers an extensive selection of premium restaurants, bars, and high-end shopping facilities.













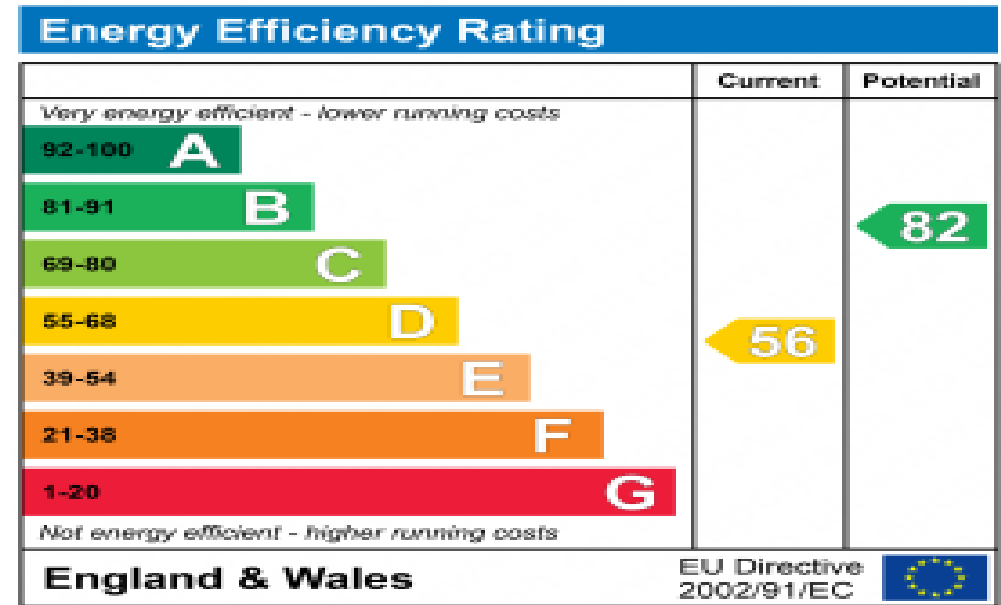

Floor plan

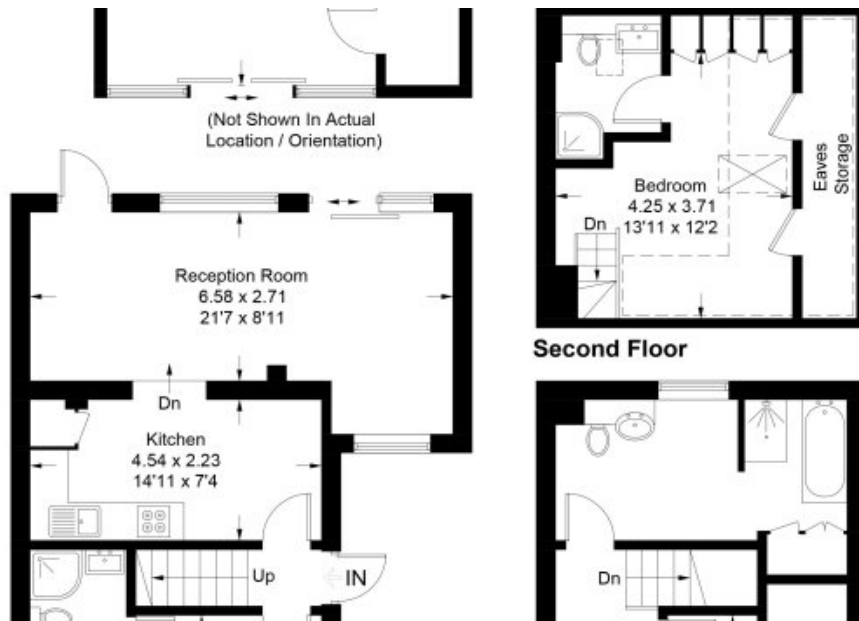

Location



Hamptons

INTERNATIONAL

+44 (0)20 8618 4551

international@hamptons.co.uk

www.hamptons-international.com