

# Hamptons

INTERNATIONAL

---

**380 Elm Ave, Rahway, NJ 07065**

5 🏠 2 🚗

**£490,000**

**(\$650,000)**

## Property details

---



### Key features

- **Cooling: Window A/C**
- **Fireplace Count: 1 Fireplace**
- **Garage Count: 1 Car Garage**
- **Heating - Fuel Type: Gas**
- **Sewer: Public**
- **Water: City Water**
- **Special Program: Global Luxury**

**380 Elm Ave, Rahway, NJ 07065**

5 🏠 2 🚗

**£490,000**  
**(\$650,000)**

## Description

Welcome to this classic Center Hall Colonial, ideally situated on a picturesque tree-lined street in the historic town of Rahway. This inviting home features a thoughtfully updated kitchen complete with stainless steel appliances, sleek quartz countertops, a stylish subway tile backsplash, and an abundance of cabinetry offering both beauty and functionality perfect for cooking and storage. The adjacent dining area, designed with an open-concept layout, creates a seamless flow ideal for everyday living and entertaining. The spacious living room features a cozy wood-burning fireplace, making it the perfect spot for relaxing or hosting guests. Just off the living room, you'll find a bright and welcoming family room, providing additional living space ideal for everyday comfort. The 2nd floor is thoughtfully appointed with 3/4 bedrooms, and a full bathroom. The third floor adds even more flexibility with two additional bedrooms, ideal for guests, extended living, or creative space. Step outside to enjoy a private backyard with a covered patio ideal for outdoor dining, gatherings, or simply unwinding in your own peaceful retreat. Conveniently located near NYC transportation and Newark Liberty International Airport, this home also provides easy access to downtown Rahway's vibrant mix of dining, entertainment, arts, fitness, shopping, and schools. This beautiful, move-in-ready home offers the perfect blend of modern updates, charm, comfort, and convenience. Come make it yours! Bedroom 14.0ft x 14.0ft Bedroom 10.0ft x 13.0ft Bedroom 9.0ft x 13.0ft Bedroom 12.0ft x 13.0ft Dining Room 12.0ft x 13.0ft Family Room 9.0ft x 19.0ft Kitchen 9.0ft x 13.0ft Living Room 13.0ft x 22.0ft



































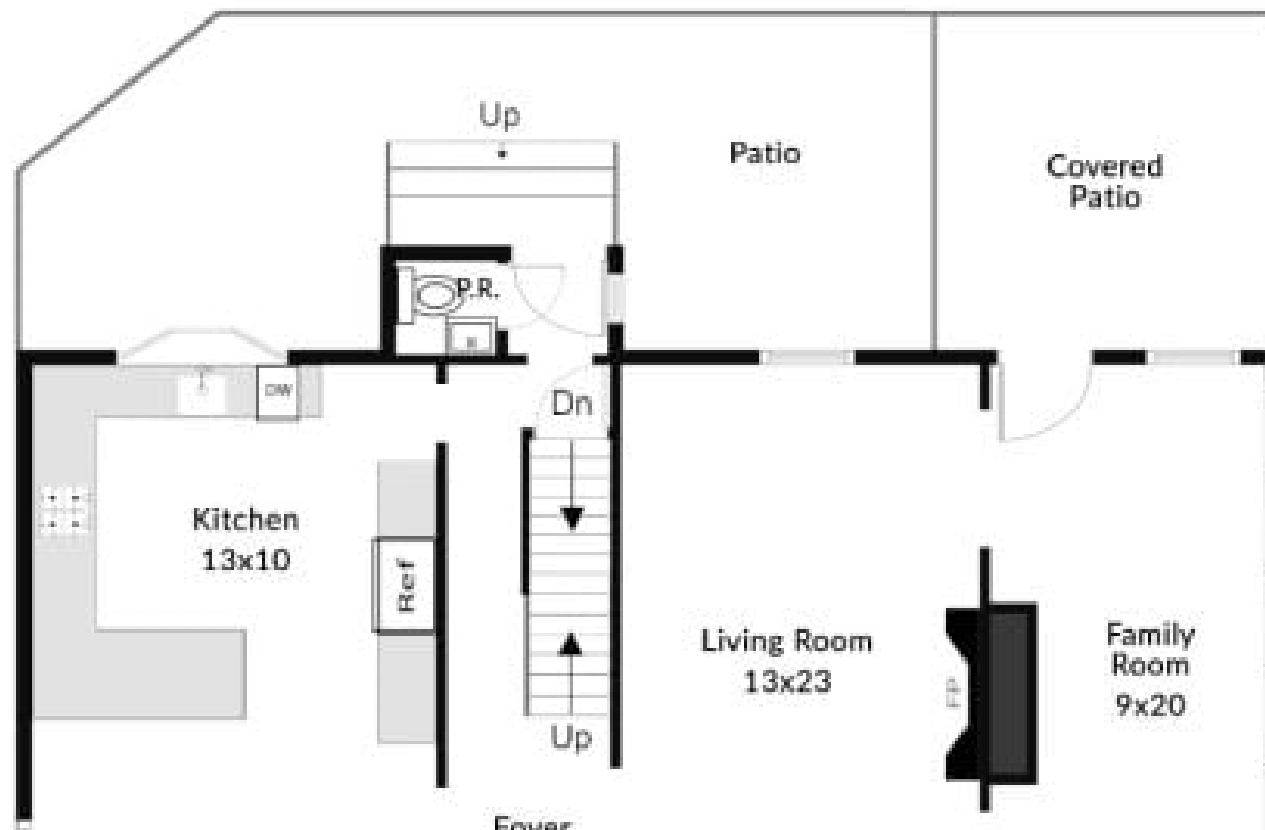

## Location

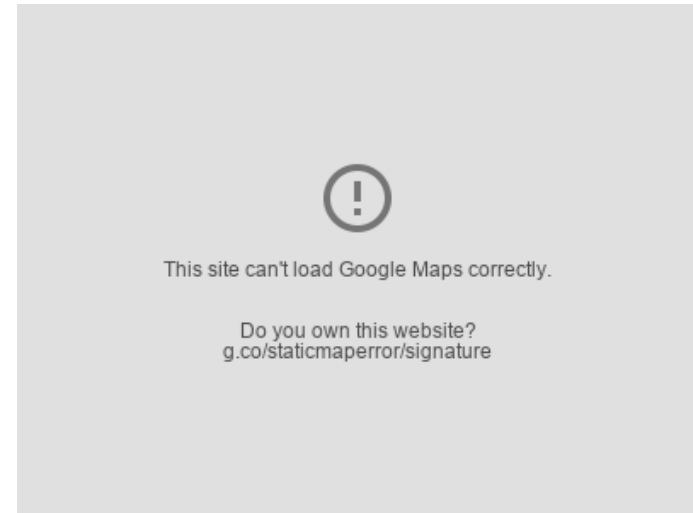
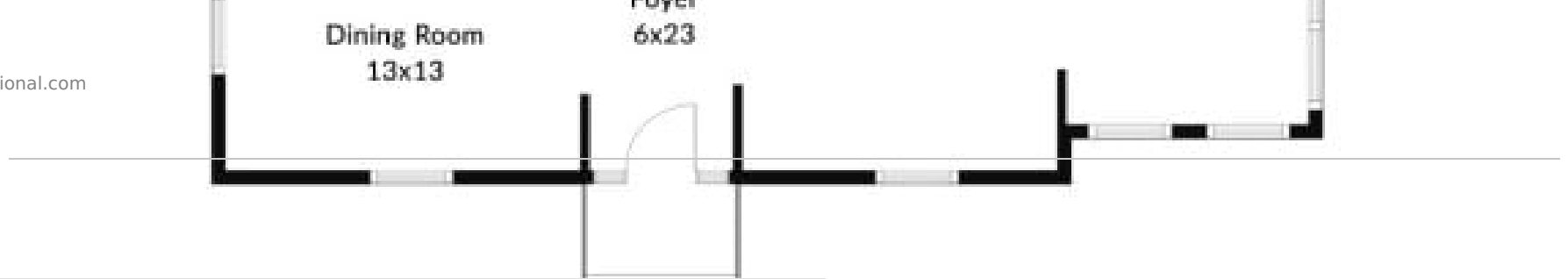

# Hamptons

INTERNATIONAL

**+44 (0)20 8618 4551**

**[international@hamptons.co.uk](mailto:international@hamptons.co.uk)**

**[www.hamptons-international.com](http://www.hamptons-international.com)**