

Hamptons

INTERNATIONAL



Wallis House, Courtlands Park, Banstead, SM7

5  4 

GUIDE PRICE

£2,000,000

(£1,995,000)

Property details



Key features

- ***Part Exchange Available**
- **13 Architecturally Striking Contemporary Homes**
- **Gated Entrance with Cherry Tree Lined Driveway**
- **Set in 43 Acres of Communal Ground**
- **Bespoke British Made Kitchen with Integrated Appliances**
- **Principal Bedroom with Dressing Room**
- **4 Further Bedrooms & 3 Bathrooms**
- **Separate Utility Room & WC**
- **Underfloor Heating Throughout**
- **Integrated Garage & Driveway Park**

Wallis House, Courtlands Park, Banstead, SM7

GUIDE PRICE

£2,000,000

(£1,995,000)

5 🏠 4 🚗

Description

BOOK YOUR APPOINTMENT TO VIEW TODAY* * *Part Exchange AvailableBader House | Courtlands Park, BansteadApproaching. 3,700 sq. ft | Five Bedrooms | Four Bathrooms | Gated, 43-Acre Development of Just Thirteen Homes.Bader House is one of just thirteen exceptional homes, approaching 3,700sq.f.t, forming Courtlands Park, Banstead's most prestigious new gated development, set within 43 acres of beautifully maintained communal grounds.Entering into the home, you are greeted by a light-filled open plan kitchen / dining / family room with floor to ceiling windows on each floor flooding the house with light and offer lovely views towards the gardens and the fields beyond. The British made kitchen includes a full suite of Miele appliances including ovens, dishwasher, fridge/freezer, alongside a boiling water Quooker tap. There's an additional lounge area with a separate study just off it. A utility room, cloakroom, WC and generous storage complete the ground floor.Upon entering the property, you are welcomed into an impressive, light-filled kitchen, dining and family area, where expansive floor-to-ceiling bi-folding doors which frame views over the gardens and open fields beyond. The beautifully appointed, British-crafted kitchen features a full complement of Miele appliances, including ovens, dishwasher and fridge/freezer, together with a Quooker boiling-water tap. A separate lounge provides an additional reception space, and an adjoining study. The ground floor is completed by a utility room, cloakroom, WC and generous storage throughout.Upstairs, the principal suite occupies a generous position, complete with a walk through dressing room and a luxurious ensuite bathroom. Four additional bedrooms offer superb versatility, three of which enjoy their own ensuite facilities, in addition to a well appointed family bathroom. Underfloor heating runs throughout the home, zoned for comfort and efficiency. Every element of the property has been designed and finished to an exceptional standard, showcasing thoughtful detailing and high-quality materials throughout.Externally, a full-width rear patio creates the perfect space for alfresco dining, opening onto a fully laid-to-lawn garden. To the front, the property offers ample driveway parking along with an integrated double garage.OutsideTwo bedrooms have access to a generous balcony overlooking the lovely lawned gardens, accessed via sliding doors off the living room. A full-width patio is the ideal space for alfresco dining, and there's plenty of parking at the front in addition to the double garage. Residents of Courtland Park also have access to 43 acres of communal grounds.SituationThe location is simply superb. Situated off Park Road and within walking distance to The Mint public house and the serene Banstead Woods, you have nature and convenience at your doorstep. Banstead Village is just a short walk away with its bustling high street, offering an array of cafes, restaurants and local stores, including a Waitrose and M&S food hall. Nearby, independent schools, such as Banstead Prep and Abedour are always in high demand, while there are some superb local state schools too. Convenient access by car to M25 & M23, there are also mainline trains from Chipstead, Banstead or Sutton, and for the golf enthusiast, notable golf courses include Banstead Downs, Chipstead, Kingswood, and the RAC Country Club at Woodcote Park. Property Ref Number: HAM-63706Additional Information*Part Exchange - available T&Cs apply Designed with exceptional attention to detail and featuring underfloor and zoned heating throughout, Bader House offers an impressive 3,657 square feet of accommodation, generous gardens and extensive parking













Floor plan

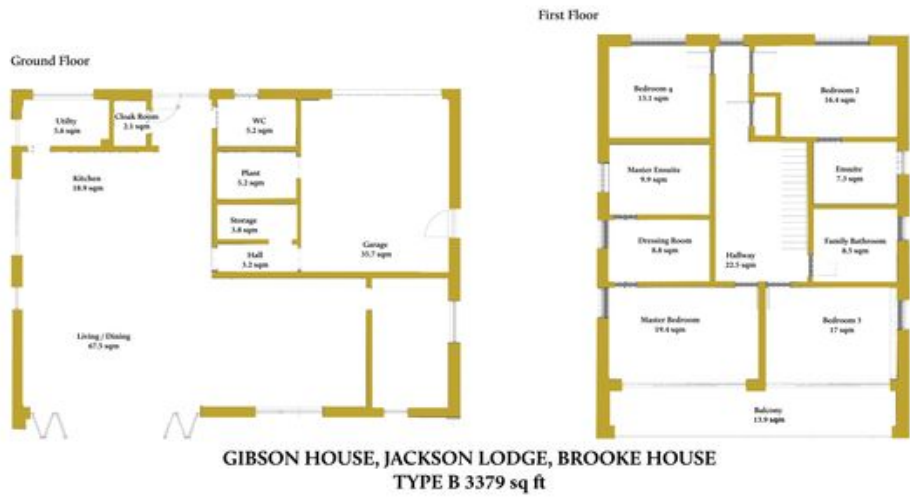

Location



This site can't load Google Maps correctly.

Do you own this website?
g.co/staticmaperror/signature



This site can't load Google Maps correctly.

Do you own this website?
g.co/staticmaperror/signature

Hamptons

INTERNATIONAL

+44 (0)20 8618 4551

international@hamptons.co.uk

www.hamptons-international.com